



# M2JA系列 危险环境用隔爆型三相异步电动机

## 公司简介

上海ABB电机有限公司成立于1995年12月，隶属于世界500强ABB集团，是专门生产和销售低压交流三相异步电动机（机座号71-355）的企业。

公司提供符合IEC标准的各种电机，可满足不同行业需求，其产品包括标准电机、变频电机、船用电机、隔爆电机、烟道电机、多速电机、制动电机、户外电机、无火花电机、铝壳电机、磨头电机。并可提供按客户要求设计的特殊电机，所有设计均可达到客户的严格要求。同时，公司可提供具有不同绝缘等级，并能满足不同电压和频率要求的各种电机。公司主要OEM客户是空调风机、港机及起重机、泵业、减速机、机床、纺织机械、玻璃机械、船用、电厂辅机、电路板机械等行业领先企业。项目覆盖：电厂、制浆造纸、石化、冶金、船舶、港口、建筑、水泥、机场等。目前，公司生产的45%的电机通过ABB国际销售网络出口国外，主要是欧洲市场。

作为中国第一家获得ISO9001质量管理体系认证和ISO14001环境管理体系认证的中小型电机制造厂。上海ABB电机有限公司以其良好的管理和先进的技术，向客户提供世界顶级的ABB产品和服务。



## Company Introduction

Founded in December 1995, ABB Shanghai Motors Co., Ltd., belongs to ABB Group, one of the world's Top 500 Corporations, and specializes in manufacturing and marketing low voltage AC 3-phase asynchronous motors of frame size from 71 to 355.

The company offers a wide range of IEC Standard motors to meet the demands of various industries, including Standard Motors, Frequency Conversion Motors, Marine Motors, Flameproof Motors, Smoke Venting Motors, Multi-speed Motors, Brake Motors, Outdoor Environment Motors, Non-sparking Motors, Aluminum Motors, and Motors for Glass Machinery, together with specially customized motors as per customers' demands and meeting customers' stringent requirements. In addition, the company can supply a broad range of motors with various insulation classes, which can meet various voltage and frequency requirements. The company major OEM customers are leaders in HVAC, crane, pump, gearbox, machine tool, textile, glass, marine, power plant auxiliary equipment, circuit board, etc. And its projects cover: power plant, pulp and paper, PEC, metal, marine, port, building, cement, airport, etc. Forty-five percent of its motors are currently exported abroad, mainly to the European market.

As the first small-medium motor manufacturer with ISO9001 Certification and ISO14001 Certification in China, ABB Shanghai Motors Co., Ltd. Provides its customers with world-class ABB products and service with qualified management and advanced technology.



# 目录 Content

M2JA系列突出特点 Outstanding Features of M2JA Motors .....	4
ABB电机产品特点 ABB Product Features .....	4
产品概述 Summary .....	5
标准 Standards .....	6
导言 Preamble .....	6
Ex d 电动机使用场所 Application area of Ex d Motors .....	6
技术特点 Technical Features .....	7
型号说明 Type Designations .....	8
隔爆型电动机的防爆标记 The Marking of Flameproof Motors .....	8
安装结构型式 Mounting Arrangement (IM) .....	8
工作条件 Working Conditions .....	9
轴承型号和电缆入口 Bearings and Cable Entry .....	9
电压与性能参数 Voltage and Technical Data .....	9
铭牌 Rating plate .....	10
电机用于其他电压 Motors For Other Voltages .....	11
订货须知 How to Place an Order .....	12
产品代码说明 Explanation of the Product Code .....	12
电机技术数据表 Technical Data Table .....	13
电动机外形图 Dimension Drawing .....	19
中外隔爆电机等级的分类 Foreign Flameproof Group Classification .....	22
外壳的类别所对应的各种可燃性气体或蒸汽及其分组 To Show the Group of Enclosures Suitable For a Particular Flammable Gas or Vapour and Its Classification .....	22
点燃组别的分类 Specifications of Ignition Group for Flameproof Motors .....	23
隔爆级组及其选用 Selection of Flameproof Motors from Type of Enclosure and Temp.Class .....	23
ATEX Ex 证书对照表 Ex Certificate(ATEX) .....	24
M2JA系列三相异步电动机变量代码(简称M2JA-VC) M2JA Motor's Variant Code .....	25

## M2JA 系列突出特点

## Outstanding Features of M2JA Motors

采用最先进的4级隔爆 (Ex d II C) 设计, 在厂区容易爆炸区域使用也能保证平稳运行。  
外壳采用全封闭风冷结构并选用高机械强度材料, 安全可靠。  
标准双频宽电压设计, 应用范围更广。

Designed and produced with advanced technology, M2JA motors can securely operate in potential explosion areas.  
High strength materials are used for the M2JA motor, assuring safety and reliability.  
Dual-frequency and wide-range voltage makes the application scope more extensive.

### ABB电机产品特点 ABB Motors Features

可靠  
High Reliability

高效  
High Efficiency

一致  
Excellent Consistency

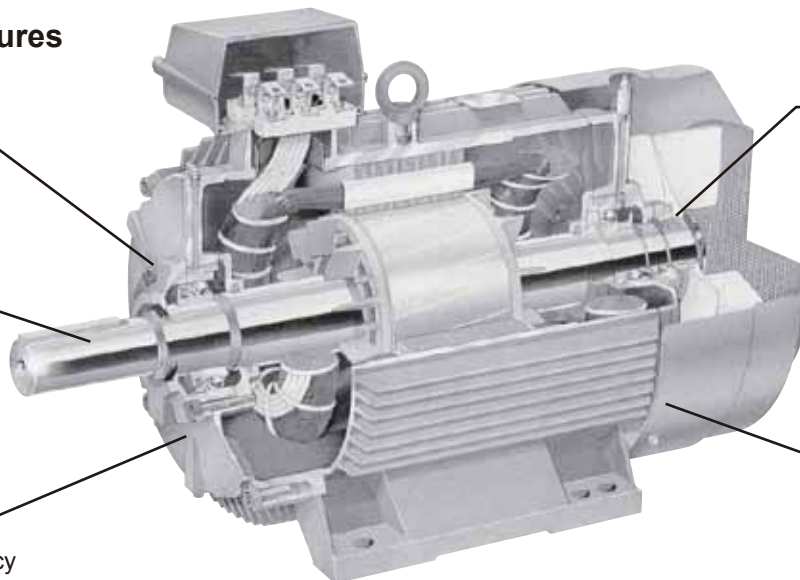

低噪音  
Low Noise

高灵活性  
High Flexibility

## 产品概述

# M2JA系列危险环境用隔爆型三相异步电动机（H80-H355）

M2JA系列危险环境用隔爆型三相异步电动机，采用“Ex d”型防爆，适用于石化工厂等危险场所，最高表面温度组别为T1~T5。其外壳能够承受通过外壳任何接触面或结构间隙渗透到电机内部的可燃性混合物造成的爆炸而不损坏，防爆性能通过LCIE（BV）认证。

## Summary

# M2JA Series Flameproof Three-phase Induction Motors for Hazardous Environments (H80-H355)

M2JA series flameproof three-phase induction motors for hazardous environments, with “Ex d” type of protection, are specially designed for zones with T1-T5 group maximum surface temperature. The M2JA series motors are certified by LCIE (BV).



## 标准

M2JA系列隔爆型电动机符合下列标准

国际标准	IEC	60079-0 60079-1
中国标准	GB	3836.1 3836.2
欧洲标准	EN	60079-0 60079-1
美国标准	UL	2279
俄罗斯标准	ГОСТ	P51330.0 P51330.1

## Standards

M2JA flameproof motors comply with the following standards:

International standards	IEC	60079-0 60079-1
Chinese standards	GB	3836.1 3836.2
European standards	EN	60079-0 60079-1
American standards	UL	2279
Russian standards	ГОСТ	P51330.0 P51330.1

## 引言

M2JA系列（80~355）隔爆型电动机是上海ABB电机有限公司引进ABB公司21世纪最新隔爆型电动机的制造技术，是目前国内最先进的工厂用4级隔爆电动机（Ex d II C）产品（温度组别T1~T5）

## Preamble

The R & D of M2JA series (80-355) flameproof motors is compatible with ABB's latest manufacturing technology. The series can be credited with the most advanced flameproof motors (Ex d II C) for factory application in china (temperature class T1-T5).

## Ex d 电动机使用场所

1.防爆危险区分为：0区、1区、2区

区域	区域定义	运用的防爆电机
0区	爆炸性区域	目前无适合的防爆电机
1区	容易爆炸区域	隔爆型“d”，增安型“e”
2区	偶然爆炸区域	隔爆型“d”，增安型“e”，无火花型“nA”电机

2.场所

石油、天然气和化学等工业部门，在生产过程中有可能产生各种可燃性气体或蒸汽，如炼油厂有丙烷、丁烷、汽油、乙烯及乙炔等；化肥厂有氨、甲醇、氧化碳、水煤气、空气等。这些物质与空气混合后就形成了具有爆炸危险性的混合物，如果这种混合物处于爆炸的温度，又遇有火源时，就会引起爆炸的严重事故。

鼠笼型电动机在正常情况下不产生火花，但在运转过程中，由于绕阻缘损伤、老化而造成短路，产生火花；或因导电零件连接松弛引起电弧，或由于机械故障及其它原因导致电动机过载、堵转产生高温，成为点火源。

因此，各种类型的防爆电动机必须围绕火花、电弧及危险温度采取有效措施。

“Ex d”型隔爆电机是防爆电机的一种防爆形式，其外壳能够承受通过外壳任何接合面或结构间隙渗透到外壳内部的可燃性混合物在内部爆炸而不损坏，并且不会引起外部由一种、多种气体或蒸汽型成的爆炸性气体环境的点燃。

## Application area of Ex d Motors

1.Explosive potential areas are divided into Zone 0, Zone 1 and Zone 2

Zone	Zone definition	Applicable motors Protection.
0	Explosive zone	No applicable motors for the time being
1	Incidental explosive zone	Flameproof "d", Increased safety"e"
2	Accidental explosive zone	Flameproof "d", Increased safety"e",non-sparking"nA"motors

### 2.location

In industries like petroleum, natural gas and chemical, the production process may lead to inflammable gas or vapour.For instance, there exist propane, butane, gasoline, ethylene, acetylene, etc.in oil refineries, and ammonia,methanol,carbon oxide,water gas, water gas,hydrogen, etc. in chemical fertilizer plants.These inflammable substances may form an explosive mixture subject to a blend of air. A serious explosive may occur if the mixture is in an explosive ambience, co-existing with tinder.

Normally, squirrel-cage motors do not produce sparks.during operation,sparks may appear due to damage and aging of winding insulation; or electric arcs because of loose connection between electric parts; mechanical failure or other reasons that may give rise to an overload of the motor and bring about high temperature, thus result in an ignition.

Therefore,effective measures should be taken for all types of flameproof motors against sparks, electricarcs and dangerous temperatures.

"Ex d" flameproof motor is a type of electrical apparatus operating in explosive zones. its enclosure will be able to withstand an explosion of inflammable gas or vapour, which penetrates into the internal part of it through any joints of structural openings. openings. furthermore, this explosion will not cause ignition in the external explosive gas atmosphere formed by one or more types of gas or vapour.

## 技术特点

- ❖ 双频宽电压  
电压范围220V-690V\*,适用50Hz和60Hz电源。
- ❖ 噪声低  
通过优化电磁设计、通风状况、结构尺寸等技术，M2JA系列电动机的噪声较低。
- ❖ 轴承负载能力高  
电动机选用深沟球轴承，寿命长，机座号80-132电动机为永久型润滑，机座号160-355电机设有加油装置。
- ❖ 可靠性好  
电动机为全封闭风冷结构，防护等级IP55，材料及工艺符合环境要求。电动机机械强度高，坚固耐用，防锈防腐性强。绕组可靠性好，采用F级绝缘结构，B级考核。并可根据用户需要增加PTC热敏电阻。

\*H100及以下为220V~480V，详见证书表（P23）

## Technical Features

- ❖ Dual frequency, wide voltage  
the rated voltage is 220V-690V, 50Hz and 60Hz supplies applicable.
- ❖ Low noise  
The M2JA range has been designed to minimize motors noise levels, by means of improving magnetic and electrical design, ventilator condition, and structure assembling size and technology.
- ❖ Bearings with high load capacity  
Motors are provided with deep-groove ball bearings, the lifetime is extended. motors in sizes80-132 are greased for life, and those in sizes 160-355 have a regreasing device as a standard.
- ❖ High reliability  
Motor are to totally enclosed fan cooled Ip55.materials and procedures satisfy with environmental requirements. the motor is mechanically strong and corrosion resistant. windings have a good reliability in class Finsulation, and class Binspection. PTC thermistors are available on request.

\*220V~480V for H100 or less. Please refer to the certificate form （P23） for the details.

## 型号说明

### Type Designations

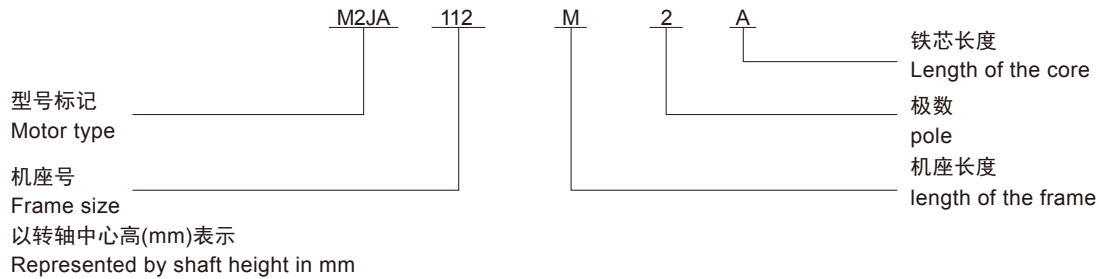

## 隔爆型电动机的防爆标记

### The Marking of Flameproof Motors

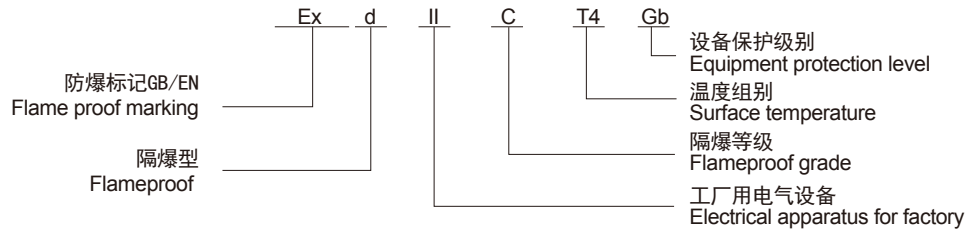

## 安装结构型式

- ❖ B3 机座带底脚，端盖无凸缘。
- ❖ B5 机座不带底脚，端盖有凸缘。
- ❖ B35 机座带底脚，端盖有凸缘。

## Mounting Arrangement (IM)

- ❖ B3 Foot-mounted motor
- ❖ B5 Flange-mounted motor
- ❖ B35 Foot-mounted and flange-mounted motor

基本结构形式 Fundamental arrangement	IMB3 (IM1001)					
安装结构形式 Mounting arrangement	IMB3 (IM1001)	IMB6 (IM1051)	IMB7 (IM1061)	IMB8 (IM1071)	IMV5 (IM1011)	IMV6 (IM1031)
示意图 Diagram						
制造范围 (机座号) Range of manufacture (frame size)	80~355	80~225				

基本结构形式 Fundamental arrangement	IMB5 (3001)			IMB35 (2001)		
安装结构形式 Mounting arrangement	IMB5 (IM3001)	IMV1 (IM3011)	IMV3 (IM3031)	IMB35 (IM2001)	IMV15 (IM2011)	IMV35 (IM2031)
示意图 Diagram						
制造范围 (机座号) Range of manufacture (frame size)	80~280	80~355	80~225	80~355	80~355	80~225



## 工作条件

环境空气温度随季节而变但不超过-40°C~+40°C\*

海拔:不超过1000m

频率:50Hz/60Hz

电压:220V~690V

工作方式:连续(S1)

起动方式:满压起动、Y-Δ起动或电抗起动

传动方式:可采用弹性联轴器或正齿轮传动绝缘、升温:F级。但定子绕组温升限值为80K即按B级考核(电阻法)。轴承允许温度不超过95°C(温度计法)。

冷却方法:IC411

Ex认证适用于不带变频器驱动的转速固定的电动机。

\*禁止在-40°C~-20°C之间直接起动电机:

通过装加热带或在定子绕组内通以一定时间的低电压来预热电机。在绕组中产生的直流电流不应超过铭牌上标明的额定电流。

## Working Conditions

Ambient temperature: to be altered with the change of seasons, but do not exceed-40°C+40°C\*

Altitude:to be used lower than 1,000 meters above sea level.

Rated frequency:50Hz/60Hz

Rated voltage:220V~690V

Duty:Continuous (S1)

Method of starting:can be started on full voltage motors and can be started with y- starter or reactor.

Driving method:flexible coupling or spur gear can be used for driving.

Insulation and temperature rise;class F.But the temp,rise of the stator windings is limited at 80K,i.e.treated sa class B(resistance method).Permissible working temp.of bearing should not be over 95°C(thermometer method).

Cooling method;IC411

Excertification applies to a fixed speed motor without frequency convertor.

\*Direct starting under range-40°C to -20°C is prohibited.

Appropriate measures should be taken to preheat motors to keep the temperature on the heaters and heating stator windings with low voltage supply for a certain time.this direct current generating is the windings shall not exceed the rated current on the nameplate.

## 轴承型号和电缆入口 Bearings and Cable Entry

下表列出了标准配置下的单列深沟球轴承。80-132标配封闭轴承,160-355标配开启式轴承。

The motors are normally fitted with single-row deep groove ball bearings as listed in the table below. Close-type bearing is provided as standard for 80-132, open-type bearing for 160-355.

Type	poles	standard bearing type		cable entry(mm)		Type	poles	standard bearing type		cable entry(mm)	
		D-end	N-end	主电缆孔 Main	辅助接线孔* Auxiliary			D-end	N-end	主电缆孔 Main	辅助接线孔* Auxiliary
80M	2,4,6	6204 C3	6204 C3	1-M25×1.5	2-M20×1.5	250M	2,4,6,8	6315 C3	6313 C3	2-M63×1.5	2-M20×1.5
90S	2,4,6	6205 C3	6205 C3	1-M25×1.5	2-M20×1.5	280S	2	6316 C3	6316 C3	2-M63×1.5	2-M20×1.5
90L	2,4,6	6205 C3	6205 C3	1-M25×1.5	2-M20×1.5	280S	4,6,8	6316 C3	6316 C3	2-M63×1.5	2-M20×1.5
100L	2,4,6,8	6206 C3	6206 C3	1-M32×1.5	2-M20×1.5	280M	2	6316 C3	6316 C3	2-M63×1.5	2-M20×1.5
112M	2,4,6,8	6207 C3	6207 C3	1-M32×1.5	2-M20×1.5	280M	4,6,8	6316 C3	6316 C3	2-M63×1.5	2-M20×1.5
132S	2,4,6,8	6208 C3	6208 C3	1-M32×1.5	2-M20×1.5	315S	2	6316 C3	6316 C3	2-M63×1.5	2-M20×1.5
132M	2,4,6,8	6208 C3	6208 C3	1-M32×1.5	2-M20×1.5	315S	4,6,8	6319 C3	6316 C3	2-M63×1.5	2-M20×1.5
160M	2,4,6,8	6309 C3	6309 C3	2-M40×1.5	1-M20×1.5	315M	2	6316 C3	6316 C3	2-M63×1.5	2-M20×1.5
160L	2,4,6,8	6309 C3	6309 C3	2-M40×1.5	1-M20×1.5	315M	4,6,8	6319 C3	6316 C3	2-M63×1.5	2-M20×1.5
180M	2,4,6,8	6310 C3	6309 C3	2-M40×1.5	1-M20×1.5	315L	2	6316 C3	6316 C3	2-M63×1.5	2-M20×1.5
180L	2,4,6,8	6310 C3	6309 C3	2-M40×1.5	1-M20×1.5	315L	4,6,8	6319 C3	6316 C3	2-M63×1.5	2-M20×1.5
200L	2,4,6,8	6312 C3	6310 C3	2-M50×1.5	2-M20×1.5	355M	2	6319M C3	6319M C3	2-M80×1.5	2-M20×1.5
225S	2,4,6,8	6313 C3	6312 C3	2-M50×1.5	2-M20×1.5	355M	4,6,8	6322 C3	6319 C3	2-M80×1.5	2-M20×1.5
225M	2,4,6,8	6313 C3	6312 C3	2-M50×1.5	2-M20×1.5	355L	2	6319M C3	6319M C3	2-M80×1.5	2-M20×1.5
						355L	4,6,8	6322 C3	6319 C3	2-M80×1.5	2-M20×1.5

\*辅助接线孔为需要时的PTC,加热元件出线孔,表中所列为最大可配置数,用户可在其中进行选配。如果用户无特殊要求为标准配置,只有主电缆孔。

\*Auxiliary cable entries are available when PTCand heating component are needed. There are the max. auxiliary cable entries listing in the table and can be chosen by customers. The standard motor only have main cable entry if there are no special requirements.

## 电压与性能参数

M2JA系列电机采用宽电压设计,电机在各种电压工况下的效率、功率因数及转速略有变化。

50Hz: 220-240V/380-420V; 380-420V/660-690V, Δ/Y接。

60Hz: 460V;<4kW,Y接; ≥4kW,Δ接。

如用户需要特定工作电压,可按特殊要求供应。

## Voltage and Technical Data

M2JA series allow a wide-range operational supply voltage,the efficiency,power fator ,and speed show minimun changes within the specified voltage ranges.

Non-standard voltages are available on request.

铭牌  
Rating Plate

<b>ABB</b>		ABB Motors Shanghai, China	
3~mot. M2JA132S4A			
1430/1700 r/min		5.5/6.33 kW Ex d IIC T4 Gb	
cos $\phi$ 0.85/0.86		Cl. F IP 55 AMB 40 °C	
V	380-420 $\Delta$	A	11.3 50
	660-690 Y		6.52 50
	440-480 $\Delta$		11.23 60
3GJA131101-ADC			
6208 DDU/C3		6208 DDU/C3	
Q/JBQS 45		No.	
Cert.No. LCIE 04 ATEX6099			
CE 0081		IEC60034-1	
II2G		Date	

<b>ABB</b>		ABB Motors Shanghai, China	
3~mot. M2JA80M8A			
700/825 r/min		0.18/0.21 kW Ex d IIC T4 Gb	
cos $\phi$ 0.60/0.56		Cl. F IP 55 AMB 40 °C	
V	220-240 $\Delta$	A	1.56 50
	380-420 Y		0.90 50
	440-480 Y		0.86 60
3GJA084301-BSC			
6204 DDU/C3		6204 DDU/C3	
Q/JBQS 45		No.	
Cert.No. LCIE 04 ATEX6095			
CE 0081		IEC60034-1	
II2G		Date	

<b>ABB</b>		ABB Motors Shanghai, China	
3~motor M2JA225M4A			
IEC 225M60		Ex d IIC T 4 Gb	
S1		No.	
Date		Ins.cl. F	
IP 55		AMB 40°C	
V	Hz	kW	r/min
A	cos $\phi$		
690 Y	50	45	1480
400 $\Delta$	50	45	1480
660 Y	50	45	1475
380 $\Delta$	50	45	1475
415 $\Delta$	50	45	1480
440 $\Delta$	60	51.8	1770
83.23	0.88		
Prod.code 3GJA222301-ADC			
Cert.no LCIE 04 ATEX 6103			
6313/C3		6312/C3	
		kg	
CE 0081		II2G	
		IEC 60034-1	
		Q/JBQS 45	

## 电机用于其他电压 Motors For Other Voltages

50Hz时给定电压的电机绕组也能连接到其他值的电压上。下面给出了电流和转矩的重算因数；效率，功率因数和转速大致相同。

Motors wound for a given voltage at 50HZ can also be used for other voltage, Recalculation factors for current and torque are given below; efficiency, power factor and speed remmain approximately the same.

根据需求可提供保证值

guaranteed values available on request.

电机绕组 Motor wound for	230V		400V		500V		690V	
可连接到50Hz CONNECTED TO 50Hz	220V	230V	380V	415V	500V	550V	660V	690V
与400V50Hz时保证值之比% %of values at 400V.50Hz								
功率 Output	100	100	100	100	100	100	100	100
额定电流 I <sub>N</sub>	182	174	105	98	80	75	61	58
堵转电流/额定电流 I <sub>s</sub> /I <sub>N</sub>	90	100	90	106	100	119	90	100
堵转电流/额定电流 I <sub>s</sub> /I <sub>N</sub>	90	100	90	106	100	119	90	100
最大转矩/额定电流 T <sub>MAX</sub> /T <sub>N</sub>	90	100	90	106	100	119	90	100

电机额定电压为 Rating voltage	50Hz		
	230V	400V	690V
可连接到 (50Hz) Connect to(50Hz)	220V-240V	380V-420V	660V-690V
可连接到 (60Hz) Connect to(60Hz)	253V-276V	440V-480V	

## 订货须知

### 订货举例

订购电动机时，请详细说明电动机型号、规格和产品代码。电动机的产品代码有不同的组成方法，下面列举一些例子。

A 订货时，请详细说明电动机型号、功率、同步转速、电压、频率、安装结构形式、防爆等级、防护等级和接线盒进线方式（包括进出口数目）等。

例：M2JA 160M4A、11KW，1500r/min，400/690V，50Hz，IMB3，Ex d IIC T4，IP55，两个出线孔

B 订货时，请尽量选用样本所列规格产品，如有特殊要求，经双方协议后也可供应。

A		B		C				D, E, F, G					
M2JA		100L2A		3GJA	10	1	5	01	-	A	S	C	X
				1-4	5-6	7	8-10	11	12	13	14	15	

A 电动机型号

B 电动机规格

C 产品代码

D 安装型式代码

E 电压和频率代码

F 产地代码

A Motor type

B Motor size

C Product code

D Mounting arrangement code

E Voltage and frequency code

F Generation code

## 产品代码说明

### Explanation of the Product Code

#### 第1位~第4位

##### Positions 1 and 4

3GJA=危险环境用隔爆型三相异步电动机  
3GJA=Flameproof three-phase induction motors for hazardous environment

#### 第5位~第6位

##### Positions 5 and 6

IEC机座号  
IEC frame

07 = 71	13 = 132	25 = 250
08 = 80	16 = 160	28 = 280
09 = 90	18 = 180	31 = 315
10 = 100	20 = 200	35 = 355
11 = 112	22 = 225	

#### 第7位

转速(极数)

#### Positions 7

Speed(pole pairs)

1=2极	6=12极	1=2poles	6=12poles
2=4极	7=>12极	2=4poles	7=>12poles
3=6极	8=双速	3=6poles	8=Two-speed motors
4=8极	9=多速	4=8poles	9=multi-speed motors
5=10极		5=10poles	

#### 第8位~第10位 编号

#### Positions 8 to 10

Running number series

#### 第11位

-(破折号)

#### Positions 11

-(dash)

#### 第12位

安装型式

A=底脚安装，接线盒顶置

B=大法兰安装

C=小法兰安装(80-160)

H=底脚和法兰安装

#### Positions 12

##### Mounting arrangement

A=Foot-mounted, top-mounted terminal box

B=Flange-mounted, large flange

C=Flange-mounted, small flange size(80-160)

H=Foot-and flange-mounted

#### 第13位

电压和频率代码

见相应页上的表格

#### Positions 13

Voltage and frequency code

See tables on appropriate page

#### 第14位

产地代码

C

#### Positions 14

Generation code

C

#### 第15位

VC标识代码

X

#### Positions 15

VC Identifying code

X

400V 50Hz											
功率 Output kW	型号规格 Type designation	产品代码 Product code	转速 Speed n r/min	功率 Efficiency		功率因数 Power factor cosφ	电流 Current		转矩 Torque		
				Full load 100%η	3/4 load 75%η		额定电流 I <sub>N</sub> A	堵转电流 额定电流 I <sub>s</sub> /I <sub>N</sub>	额定转矩 T <sub>N</sub> Nm	堵转转矩 额定转矩 T <sub>s</sub> /T <sub>N</sub>	最大转矩 额定转矩 T <sub>MAX</sub> /T <sub>N</sub>
3000r/min=2 poles basic design											
0.75	M2JA 80M2A3GJA	081301-**C	2840	74.2	74.8	0.85	1.72	6.1	2.52	2.2	2.2
1.1	80M2B	081302-**C	2855	76.9	78.3	0.86	2.40	7.0	3.68	2.2	2.2
1.5	90S2A	091101-**C	2850	78.3	79.4	0.87	3.18	7.0	5.03	2.2	2.2
2.2	90L2A	091501-**C	2850	80.7	81.5	0.86	4.58	7.0	7.37	2.2	2.2
3	100L2A	101501-**C	2860	82.4	83.7	0.87	6.04	7.0	10.0	2.2	2.2
4	112M2A	111301-**C	2875	83.9	85.0	0.90	7.65	7.0	13.3	2.2	2.2
5.5	132S2A	131101-**C	2905	85.5	86.1	0.89	10.4	7.0	18.1	2.2	2.2
7.5	132S2B	131102-**C	2910	86.7	88.0	0.895	14.0	7.0	24.6	2.2	2.2
11	160M2A	161301-**C	2920	88.2	88.7	0.875	20.6	6.5	36.0	2.5	3.0
15	160M2B	161302-**C	2920	89.3	90.0	0.885	27.4	6.5	49.1	2.5	3.2
18.5	160L2A	161501-**C	2920	89.8	90.9	0.895	33.2	6.5	60.5	2.5	3.2
22	180M2A	181301-**C	2940	90.4	91.7	0.90	39.0	6.5	71.5	2.3	2.8
30	200L2A	201501-**C	2955	91.2	91	0.90	52.8	6.5	97.0	2.2	2.7
37	200L2B	201502-**C	2955	91.6	91.6	0.905	64.4	6.5	120	2.3	2.7
45	225M2A	221301-**C	2970	92.1	91.3	0.89	79.2	7.0	145	2.5	2.8
55	250M2A	251301-**C	2965	92.5	92.8	0.90	95.4	7.5	177	2.4	3.0
75	280S2A	281101-**C	2970	93.1	93.1	0.91	128	7.5	241	2.5	3.3
90	280M2A	281301-**C	2970	93.4	93.6	0.92	151	7.5	289	2.3	3.2
110	315S2A	311101-**C	2980	93.6	93.4	0.90	188	7.1	353	1.8	2.2
132	315M2A	311301-**C	2980	94.2	93.8	0.90	225	7.1	423	1.8	2.2
* 160	315L2A	311501-**C	2975	94.2	94.0	0.90	272	7.2	514	1.8	2.2
* 200	315L2B	311502-**C	2975	94.4	94.5	0.91	336	7.2	642	1.8	2.2
* 250	355M2A	351301-**C	2980	94.5	94.5	0.90	424	7.1	801	2.3	2.8
* 315	355L2A	351501-**C	2980	94.8	94.6	0.90	533	6.9	1009	2	2.8

400V 50Hz											
功率 Output kW	型号规格 Type designation	产品代码 Product code	转速 Speed n r/min	功率 Efficiency		功率因数 Power factor cosφ	电流 Current		转矩 Torque		
				Full load 100%η	3/4 load 75%η		额定电流 I <sub>N</sub> A	堵转电流 额定电流 I <sub>s</sub> /I <sub>N</sub>	额定转矩 T <sub>N</sub> Nm	堵转转矩 额定转矩 T <sub>s</sub> /T <sub>N</sub>	最大转矩 额定转矩 T <sub>MAX</sub> /T <sub>N</sub>
1500r/min=4 poles basic design											
0.55	M2JA 80M4A3GJA	082301-**C	1410	72.0	72.5	0.73	1.51	5.2	3.73	2.4	2.0
0.75	80M4B	082302-**C	1415	74.2	75.6	0.755	1.93	6.0	5.06	2.4	2.2
1.1	90S4A	092101-**C	1395	76.3	76.8	0.765	2.72	6.0	7.53	2.3	2.2
1.5	90L4A	092501-**C	1400	78.3	80.6	0.78	3.54	6.0	10.2	2.3	2.2
2.2	100L4A	102501-**C	1430	80.7	81.3	0.79	4.98	6.0	14.7	2.3	2.2
3	100L4B	102502-**C	1425	82.4	83.6	0.81	6.49	6.5	20.1	2.3	2.2
4	112M4A	112301-**C	1435	83.9	84.1	0.775	8.88	6.5	26.6	2.3	2.2
5.5	132S4A	132101-**C	1435	85.5	86.2	0.82	11.3	6.5	36.6	2.3	2.2
7.5	132M4A	132301-**C	1440	86.7	87.6	0.83	15.0	6.5	49.7	2.3	2.2
11	160M4A	162301-**C	1460	88.2	89.1	0.85	21.2	6.5	72.0	2.4	2.8
15	160L4A	162501-**C	1455	89.3	90.8	0.86	28.2	6.5	98.5	2.3	2.4
18.5	180M4A	182301-**C	1470	89.8	90.4	0.86	34.6	6.5	120	2.3	3.0
22	180L4A	182501-**C	1470	90.4	90.1	0.875	40.1	6.5	143	2.4	3.1
30	200L4A	202501-**C	1475	91.2	91.8	0.87	54.6	6.5	194	2.2	2.8
37	225S4A	222101-**C	1480	91.6	92.1	0.86	67.8	7.0	239	2.2	2.8
45	225M4A	222301-**C	1480	92.1	92.3	0.86	82.0	7.0	290	2.2	2.8
55	250M4A	252301-**C	1475	92.5	92.8	0.88	97.5	7.0	356	2.4	3.0
75	280S4A	282101-**C	1480	93.1	93.7	0.88	132	6.5	484	2.4	2.6
90	280M4A	282301-**C	1480	93.6	93.8	0.89	156	7.2	581	2.3	2.8
110	315S4A	312101-**C	1485	93.6	93.7	0.87	195	6.9	707	2.1	2.2
132	315M4A	312301-**C	1480	93.8	93.8	0.875	232	6.9	849	2.1	2.2
* 160	315L4A	312501-**C	1485	94.0	94.0	0.875	281	6.9	1029	2.1	2.2
* 200	315L4B	312502-**C	1480	94.2	94.2	0.875	350	6.9	1286	2.1	2.2
* 250	355M4A	352301-**C	1485	94.4	94.4	0.90	425	6.9	1602	2.1	2.6
* 315	355L4A	352501-**C	1485	94.8	94.8	0.90	533	7.0	2019	2.1	2.3

\*Insulation Class F Temperature rise Class F

D	S	
380~420V△50Hz	220~240V△50Hz	其他电压频率（最大值，690V）可通过添加VC002，VC209实现。（VC定义请见后页VC适用表） Other rated voltage connection or frequency(Max,690V)can be used with VC002 or VC209.(The meaning of Variet code can be referred to Variant Code List)
660~690VY50Hz	380~420VY50Hz	
440~480 <sup>1)</sup> V△60Hz	440~480VY60Hz	
<sup>1)</sup> 480V not stamped on sizes 160 to 355		

380V 50Hz						415V 50Hz						
功率 Output kW	型号规格 Type designation	转速 Speed n r/min	效率 Efficiency η%	功率因数 power factor cosφ	电流 Current A	转速 Speed n r/min	效率 Efficiency η%	功率因数 Power factor cosφ	电流 Current A	转动惯量 Moment of inertia J=GD <sup>2</sup> /4 Kgm <sup>2</sup>	重量 Weight kg	噪声 Sound pressure level Lp dB(A)
3000r/min=2 poles						basic design						
0.75	80M2A	2825	73.7	0.86	1.80	2855	74.7	0.84	1.66	0.00091	30	57
1.1	80M2B	2840	76.2	0.87	2.52	2870	77.4	0.845	2.34	0.00107	31	58
1.5	90S2A	2835	77.8	0.885	3.31	2865	78.8	0.86	3.08	0.00135	34	61
2.2	90L2A	2835	80.2	0.88	4.74	2865	81.0	0.83	4.55	0.00163	40	61
3	100L2A	2845	82.0	0.88	6.32	2870	82.8	0.845	5.97	0.00402	46	65
4	112M2A	2860	83.1	0.915	7.99	2890	84.4	0.88	7.49	0.00671	61	67
5.5	132S2A	2890	84.8	0.90	10.9	2910	86.0	0.875	10.2	0.01241	79	70
7.5	132S2B	2900	86.0	0.90	14.7	2920	87.2	0.89	13.4	0.01491	84	70
11	160M2A	2910	87.6	0.885	21.6	2930	88.2	0.85	20.4	0.0436	149	72
15	160M2B	2910	89.3	0.895	28.5	2930	89.8	0.875	26.6	0.0551	161	72
18.5	160L2A	2910	89.8	0.905	34.6	2930	90.3	0.885	32.2	0.06549	185	72
22	180M2A	2935	90.4	0.91	40.6	2950	90.4	0.88	38.5	0.08805	216	75
30	200L2A	2950	91.2	0.91	54.9	2960	91.2	0.89	51.4	0.14821	312	81
37	200L2B	2950	91.6	0.915	67.1	2960	91.6	0.895	62.8	0.16822	329	81
45	225M2A	2965	92.1	0.90	82.5	2970	92.1	0.875	77.7	0.29345	406	81
55	250M2A	2960	92.3	0.905	100	2965	92.5	0.89	92.9	0.3784	488	84
75	280S2A	2965	92.8	0.92	133	2970	93.1	0.905	124	0.587	630	85
90	280M2A	2965	93.1	0.925	159	2970	93.4	0.915	147	0.615	700	85
110	315S2A	2975	93.6	0.905	197	2980	93.6	0.89	184	1.4083	1138	88
132	315M2A	2975	94.2	0.905	235	2980	94.2	0.89	219	1.5584	1263	88
* 160	315L2A	2975	94.2	0.91	284	2980	94.2	0.89	266	1.7256	1338	88
* 200	315L2B	2970	94.4	0.915	352	2975	94.4	0.90	327	1.9405	1400	88
* 250	355M2A	2980	94.5	0.905	444	2980	94.5	0.895	411	3.05	1798	89
* 315	355L2A	2980	94.8	0.905	558	2980	94.8	0.895	517	3.6	2158	89

380V 50Hz						415V 50Hz						
功率 Output kW	型号规格 Type designation	转速 Speed n r/min	效率 Efficiency η%	功率因数 power factor cosφ	电流 Current A	转速 Speed n r/min	效率 Efficiency η%	功率因数 Power factor cosφ	电流 Current A	转动惯量 Moment of inertia J=GD <sup>2</sup> /4 Kgm <sup>2</sup>	重量 Weight kg	噪声 Sound pressure level Lp dB(A)
1500r/min=4 poles						basic design						
0.55	80M4A	1400	71.5	0.75	1.56	1420	72.0	0.70	1.52	0.00145	30	46
0.75	80M4B	1405	73.2	0.78	2.00	1425	74.7	0.735	1.90	0.00174	31	46
1.1	90S4A	1385	75.7	0.785	2.81	1405	76.5	0.735	2.72	0.00254	34	52
1.5	90L4A	1390	77.8	0.795	3.68	1410	78.8	0.755	3.51	0.00317	41	52
2.2	100L4A	1420	80.2	0.81	5.15	1435	81.0	0.765	4.94	0.00679	45	53
3	100L4B	1415	81.7	0.83	6.72	1430	82.8	0.785	6.42	0.00862	52	53
4	112M4A	1430	83.6	0.805	9.03	1440	84.1	0.75	8.82	0.01306	64	56
5.5	132S4A	1425	84.7	0.84	11.7	1440	85.6	0.79	11.3	0.02673	81	59
7.5	132M4A	1430	86.1	0.84	15.8	1450	87.1	0.80	15.0	0.03432	94	59
11	160M4A	1450	88.2	0.87	21.8	1460	88.2	0.83	20.9	0.06543	152	66
15	160L4A	1450	89.3	0.88	29.0	1460	89.3	0.85	27.5	0.09349	181	66
18.5	180M4A	1465	89.8	0.88	35.6	1470	89.8	0.85	33.7	0.16049	214	66
22	180L4A	1465	90.4	0.89	41.5	1470	90.4	0.86	39.4	0.18046	232	66
30	200L4A	1470	91.2	0.885	56.5	1475	91.2	0.855	53.5	0.2819	312	71
37	225S4A	1475	91.6	0.875	70.1	1480	91.6	0.84	66.9	0.37	358	73
45	225M4A	1475	92.1	0.865	85.8	1480	92.1	0.835	81.4	0.42	396	73
55	250M4A	1475	92.3	0.89	102	1480	92.6	0.87	95.0	0.78	563	76
75	280S4A	1480	92.9	0.89	138	1480	93.1	0.875	128	1.10	668	78
90	280M4A	1480	93.4	0.90	163	1485	93.6	0.885	151	1.35	740	78
110	315S4A	1480	93.6	0.875	204	1485	93.6	0.855	191	2.8596	1163	80
132	315M4A	1480	93.8	0.885	242	1485	93.8	0.865	226	3.1848	1288	80
* 160	315L4A	1480	94.0	0.885	292	1485	94.0	0.86	275	3.6765	1313	86
* 200	315L4B	1480	94.2	0.885	364	1485	94.2	0.865	341	4.2516	1375	86
* 250	355M4A	1485	94.3	0.905	445	1490	94.4	0.895	412	6.77	1933	87
* 315	355L4A	1485	94.7	0.905	558	1490	94.8	0.895	517	8.2	2275	87

\*Insulation Class F Temperature rise Class F

D	S	
380~420V△50Hz	220~240V△50Hz	其他电压频率（最大值，690V）可通过添加VC002, VC209实现。（VC定义请见后页VC适用表） Other rated voltage connection or frequency(Max,690V)can be used with VC002 or VC209.(The meaning of Variet code can be referred to Variant Code List)
660~690VY50Hz	380~420VY50Hz	
440~480 <sup>1)</sup> V△60Hz	440~480VY60Hz	
<sup>1)</sup> 480V not stamped on sizes 160 to 355		

400V 50Hz											
功率 Output kW	型号规格 Type designation	产品代码 Product code	转速 Speed n r/min	功率	Efficiency	功率因数 Power factor cosφ	电流 Current		转矩 Torque		
				Full	3/4		额定电流 In A	堵转电流 Is/In	额定转矩 TN Nm	堵转转矩 Ts/TN	最大转矩 TMAX/TN
				load	load						
1000r/min=6 poles Basic design											
0.37	M2JA 80M6A3GJA	083301-**C	930	63.5	63.9	0.66	1.27	5.0	3.80	1.9	1.8
0.55	80M6B	083302-**C	925	65.7	66.9	0.675	1.79	5.0	5.68	1.9	1.8
0.75	90S6A	093101-**C	920	71.5	72.6	0.72	2.10	5.0	7.79	2.0	2.2
1.1	90L6A	093501-**C	920	74.3	75.5	0.74	2.89	5.0	11.4	2.0	2.2
1.5	100L6A	103501-**C	940	76.4	76.2	0.74	3.83	5.5	15.2	2.0	2.2
2.2	112M6A	113301-**C	940	78.8	79.8	0.73	5.52	5.5	22.4	2.0	2.2
3	132S6A	133101-**C	945	80.7	81.6	0.77	6.97	6.5	30.3	2.0	2.2
4	132M6A	133301-**C	950	82.3	82.9	0.77	9.11	6.5	40.2	2.0	2.2
5.5	132M6B	133302-**C	950	83.9	85.8	0.78	12.1	6.5	55.3	2.0	2.2
7.5	160M6A	163301-**C	960	85.5	86.4	0.78	16.2	6.0	74.6	2.0	2.3
11	160L6A	163501-**C	970	87.1	88.0	0.78	23.4	6.0	108	2.2	2.3
15	180L6A	183501-**C	975	88.3	88.7	0.82	29.9	6.0	147	2.3	2.8
18.5	200L6A	203501-**C	980	89.2	90.2	0.82	36.5	6.0	180	2.2	2.8
22	200L6B	203502-**C	980	89.7	90.4	0.83	42.7	6.0	214	2.1	2.8
30	225M6A	223301-**C	985	90.7	91.1	0.815	58.6	6.6	291	2.2	2.8
37	250M6A	253301-**C	975	91.3	91.6	0.87	67.2	6.8	361	2.3	2.8
45	280S6A	283101-**C	985	91.8	92.0	0.875	80.9	6.2	439	2.3	2.4
55	280M6A	283301-**C	985	92.3	92.4	0.875	98.3	7.0	536	2.3	2.5
75	315S6A	313101-**C	985	93.0	93.2	0.86	135	7.4	723	2.0	2.0
90	315M6A	313301-**C	985	93.3	93.5	0.86	162	7.4	868	2.0	2.0
110	315L6A	313501-**C	985	93.6	93.8	0.875	194	6.8	1061	2.0	2.0
132	315L6B	313502-**C	985	93.8	94.0	0.875	232	6.8	1280	2.0	2.0
* 160	355M6A	353301-**C	990	94.0	94.2	0.88	279	6.8	1543	2.1	2.4
* 200	355M6B	353302-**C	990	94.2	94.3	0.88	348	6.7	1929	2.0	2.3
* 250	355L6A	353501-**C	990	94.4	94.5	0.88	434	6.7	2412	2.0	2.3

400V 50Hz											
功率 Output kW	型号规格 Type designation	产品代码 Product code	转速 Speed n r/min	功率	Efficiency	功率因数 Power factor cosφ	电流 Current		转矩 Torque		
				Full	3/4		额定电流 In A	堵转电流 Is/In	额定转矩 TN Nm	堵转转矩 Ts/TN	最大转矩 TMAX/TN
				load	load						
750r/min=8 poles Basic design											
0.75	M2JA 100L8A3GJA	104501-**C	690	68.5	68.6	0.64	2.47	5.0	10.4	1.8	2.0
1.1	100L8B	104502-**C	675	71.3	70.1	0.645	3.45	5.0	15.6	1.8	2.0
1.5	112M8A	114301-**C	695	74.2	74.6	0.675	4.32	5.0	20.6	1.8	2.0
2.2	132S8A	134101-**C	710	79.8	80.6	0.70	5.68	5.5	29.6	1.8	2.0
3	132M8A	134102-**C	710	80.0	80.4	0.75	7.22	5.5	40.4	1.8	2.0
4	160M8A	164301-**C	720	83.0	83.0	0.73	9.53	5.5	53.1	2.1	2.5
5.5	160M8B	164302-**C	720	84.5	94.6	0.74	12.7	5.5	73.0	2.1	2.5
7.5	160L8A	164501-**C	720	85.2	84.5	0.74	17.2	5.5	99.5	2.1	2.5
11	180L8A	184501-**C	730	87.5	86.8	0.77	23.6	5.4	144	2.0	2.8
15	200L8A	204501-**C	730	89.0	89.4	0.775	31.4	5.5	196	2.3	2.8
18.5	225S8A	224101-**C	735	89.5	88.6	0.73	40.9	5.5	240	2.1	2.8
22	225M8A	224301-**C	735	89.7	88.8	0.74	47.8	6.0	286	2.2	2.8
30	250M8A	254301-**C	730	91.3	89.3	0.79	60.0	6.5	390	2.3	2.6
37	280S8A	284101-**C	735	91.2	91.0	0.80	73.2	6.0	478	2.1	2.6
45	280M8A	284301-**C	735	92.0	90.6	0.80	88.2	6.0	581	2.1	2.7
55	315S8A	314101-**C	740	92.5	91.2	0.82	105	6.9	710	1.8	2.0
75	315M8A	314301-**C	740	93.0	91.9	0.82	142	7.0	968	1.8	2.0
90	315L8A	314501-**C	740	93.5	92.9	0.82	169	7.1	1161	1.8	2.0
110	315L8B	314502-**C	740	94.0	92.4	0.825	205	6.4	1420	1.8	2.0

\*Insulation Class F Temperature rise Class F

D	S	
380~420V△50Hz	220~240V△50Hz	其他电压频率（最大值，690V）可通过添加VC002，VC209实现。（VC定义请见后页VC适用表） Other rated voltage connection or frequency(Max,690V)can be used with VC002 or VC209.(The meaning of Variant code can be referred to Variant Code List)
660~690VY50Hz	380~420VY50Hz	
440~480 <sup>1)</sup> V△60Hz	440~480VY60Hz	
<sup>1)</sup> 480V not stamped on sizes 160 to 355		

380V 50Hz						415V 50Hz						
功率 Output kW	型号规格 Type designation	转速 Speed n r/min	效率 Efficiency $\eta\%$	功率因数 power factor $\cos\phi$	电流 Current A	转速 Speed n r/min	效率 Efficiency $\eta\%$	功率因数 Power factor $\cos\phi$	电流 Current A	转动惯量 Moment of inertia $J=GD^2/4$ Kgm <sup>2</sup>	重量 Weight kg	噪声 Sound pressure level Lp dB(A)
1000r/min=6 poles												
0.37	80M6A	925	63.0	0.685	1.30	935	63.0	0.63	1.30	0.00159	31	45
0.55	80M6B	920	65.0	0.705	1.82	930	65.5	0.635	1.84	0.00196	32	45
0.75	90S6A	915	70.5	0.755	2.14	930	71.7	0.70	2.08	0.00292	34	48
1.1	90L6A	915	73.3	0.77	2.96	925	74.5	0.72	2.85	0.00379	41	48
1.5	100L6A	930	75.6	0.76	3.97	945	76.8	0.715	3.80	0.00999	45	51
2.2	112M6A	935	78.2	0.75	5.70	945	79.2	0.71	5.44	0.01559	59	54
3	132S6A	940	80.1	0.78	7.30	950	81.1	0.75	6.86	0.03116	76	56
4	132M6A	945	81.4	0.78	9.57	955	82.8	0.75	8.96	0.04074	86	56
5.5	132M6B	940	83.3	0.79	12.7	955	84.3	0.765	11.9	0.05332	96	56
7.5	160M6A	950	85.5	0.79	16.9	970	85.5	0.75	16.3	0.09231	153	61
11	160L6A	965	87.1	0.80	24.0	975	87.1	0.76	23.1	0.12970	181	62
15	180L6A	975	88.3	0.84	30.7	980	88.3	0.80	29.5	0.2418	225	63
18.5	200L6A	975	89.2	0.84	37.5	980	89.2	0.80	36.1	0.34174	294	64
22	200L6B	975	89.7	0.84	44.4	980	89.7	0.81	42.1	0.46837	308	64
30	225M6A	980	90.7	0.835	60.2	985	90.7	0.79	58.2	0.62691	385	66
37	250M6A	975	90.9	0.88	70.3	980	91.5	0.86	65.4	0.97	478	68
45	280S6A	980	91.6	0.885	84.3	985	91.8	0.865	78.8	1.25	603	69
55	280M6A	980	92.0	0.885	103	985	92.3	0.865	95.8	1.485	665	70
75	315S6A	985	92.8	0.87	141	985	93.0	0.85	132	3.1942	1150	70
90	315M6A	985	93.2	0.87	169	985	93.3	0.85	158	3.723	1263	70
110	315L6A	985	93.5	0.88	203	985	93.6	0.87	188	4.2564	1325	70
132	315L6B	985	93.6	0.88	243	985	93.8	0.87	225	5.1577	1400	75
* 160	355M6A	990	94.0	0.89	291	990	94.0	0.86	275	7.8	1700	75
* 200	355M6B	990	94.1	0.895	361	990	94.2	0.875	338	9.1	1939	75
* 250	355L6A	990	94.3	0.895	450	990	94.4	0.87	423	11.4	2571	75
380V 50Hz						415V 50Hz						
功率 Output kW	型号规格 Type designation	转速 Speed n r/min	效率 Efficiency $\eta\%$	功率因数 power factor $\cos\phi$	电流 Current A	转速 Speed n r/min	效率 Efficiency $\eta\%$	功率因数 Power factor $\cos\phi$	电流 Current A	转动惯量 Moment of inertia $J=GD^2/4$ Kgm <sup>2</sup>	重量 Weight kg	噪声 Sound pressure level Lp dB(A)
750r/min=8 poles												
0.75	100L8A	680	67.0	0.65	2.62	695	69.0	0.62	2.44	0.00971	44	53
1.1	100L8B	665	68.8	0.68	3.57	685	71.8	0.625	3.41	0.01186	50	53
1.5	112M8A	690	73.2	0.68	4.58	700	74.4	0.64	4.38	0.01559	61	55
2.2	132S8A	705	79.3	0.745	5.66	715	79.8	0.685	5.60	0.03625	77	55
3	132M8A	705	79.5	0.78	7.35	715	80.0	0.725	7.20	0.04141	85	56
4	160M8A	715	83.0	0.76	9.63	725	83.0	0.70	9.58	0.0676	139	58
5.5	160M8B	715	84.5	0.76	13.0	720	84.5	0.72	12.6	0.09524	151	58
7.5	160L8A	715	85.2	0.77	17.4	720	85.2	0.72	17.0	0.12122	177	58
11	180L8A	725	87.5	0.79	24.2	730	87.5	0.75	23.3	0.23645	222	62
15	200L8A	725	89.0	0.80	32.0	730	89.0	0.75	31.3	0.37103	308	63
18.5	225S8A	735	89.5	0.75	41.9	740	89.3	0.69	41.8	0.53287	341	65
22	225M8A	735	89.7	0.76	49.0	740	89.5	0.70	48.9	0.65825	383	65
30	250M8A	730	91.2	0.81	61.7	735	91.4	0.77	59.3	0.975	490	67
37	280S8A	735	91.1	0.81	76.2	735	91.2	0.785	71.9	1.25	610	68
45	280M8A	735	91.9	0.81	91.8	735	92.0	0.79	86.1	1.485	685	68
55	315S8A	735	92.3	0.83	109	740	92.6	0.805	103	3.6842	1163	65
75	315M8A	735	92.8	0.83	148	740	93.1	0.805	139	4.9591	1263	68
90	315L8A	740	93.3	0.83	177	740	93.6	0.805	166	5.8205	1338	68
110	315L8B	735	93.8	0.84	212	740	94.1	0.81	201	6.7537	1425	68

\*Insulation Class F Temperature rise Class F

D	S	
380~420V $\Delta$ 50Hz	220~240V $\Delta$ 50Hz	其他电压频率（最大值，690V）可通过添加VC002，VC209实现。（VC定义请见后页VC适用表） Other rated voltage connection or frequency(Max,690V)can be used with VC002 or VC209.(The meaning of Variet code can be referred to Variant Code List)
660~690VY50Hz	380~420VY50Hz	
440~480 <sup>1)</sup> V $\Delta$ 60Hz	440~480VY60Hz	
<sup>1)</sup> 480V not stamped on sizes 160 to 355		



460V 60Hz													
功率 Output kW	型号规格 Type designation	产品代码 Product code	转速 Speed n r/min	效率 Efficiency Full load 100%η	功率因数 Power factor cosφ	电流 Current		转矩 Torque			转动惯量 Moment of inertia J=GD <sup>2</sup> /4 Kgm <sup>2</sup>	重量 Weight kg	噪声 Sound pressure level Lp dB(A)
						额定电流 I <sub>N</sub> A	堵转电流 I <sub>s</sub> /I <sub>N</sub>	额定转矩 T <sub>N</sub> Nm	堵转转矩 T <sub>s</sub> /T <sub>N</sub>	最大转矩 T <sub>MAX</sub> /T <sub>N</sub>			
3600r/min=2 poles Basic design													
0.86	M2JA 80M2A 3GJA	081301-**C	3420	77.0	0.875	1.60	6.1	2.40	2.2	2.2	0.00091	30	60
1.27	80M2B	081302-**C	3430	78.5	0.87	2.33	7.0	3.54	2.2	2.2	0.00107	31	61
1.73	90S2A	091101-**C	3420	81.0	0.87	3.08	7.0	4.83	2.2	2.2	0.00135	34	64
2.53	90L2A	091501-**C	3440	81.5	0.86	4.53	7.0	7.02	2.2	2.2	0.00163	40	64
3.45	100L2A	101501-**C	3450	84.5	0.87	5.89	7.0	9.55	2.2	2.2	0.00402	46	68
4.60	112M2A	111301-**C	3475	86.0	0.91	7.38	7.0	12.6	2.2	2.2	0.00671	61	70
6.33	132S2A	131101-**C	3500	86.0	0.89	10.4	7.0	17.3	2.2	2.2	0.01241	79	73
8.6	132S2B	131102-**C	3510	87.5	0.895	13.8	7.0	23.4	2.2	2.2	0.01491	84	73
12.7	160M2A	161301-**C	3515	87.5	0.875	20.8	6.5	34.5	2.5	3.0	0.0436	149	75
17.3	160M2B	161302-**C	3515	89.5	0.895	27.1	6.5	47.0	2.5	3.2	0.0551	161	75
21.3	160L2A	161501-**C	3515	89.5	0.90	33.2	6.5	57.8	2.5	3.2	0.06549	185	75
25.3	180L2A	181301-**C	3540	89.5	0.90	39.4	6.5	68.3	2.3	2.8	0.08805	216	78
34.5	200L2A	201501-**C	3550	91.5	0.905	52.3	6.5	92.8	2.2	2.7	0.14821	312	84
42.6	200L2B	201502-**C	3550	91.7	0.91	64.1	6.5	115	2.3	2.7	0.16822	329	84
51.8	225M2A	221301-**C	3570	92.4	0.895	78.6	7.0	139	2.5	2.8	0.29345	406	84
63	250M2A	251301-**C	3565	92.4	0.90	95.1	7.5	169	2.4	3.0	0.3784	488	87
86	280S2A	281101-**C	3570	93.0	0.92	126	7.5	230	2.5	3.3	0.587	630	88
104	280M2A	281301-**C	3570	93.0	0.925	152	7.5	278	2.3	3.2	0.615	700	88
127	315S2A	311101-**C	3575	93.0	0.90	190	7.1	339	1.8	2.2	1.4083	1138	91
152	315M2A	311301-**C	3575	94.1	0.905	224	7.1	406	1.8	2.2	1.5584	1263	91
* 184	315L2A	311501-**C	3575	94.1	0.905	271	7.2	492	1.8	2.2	1.7256	1338	91
* 230	315L2B	311502-**C	3570	94.1	0.91	337	7.2	614	1.8	2.2	1.9405	1400	91
*287.5	355M2A	351301-**C	3580	94.1	0.905	424	7.1	767	2.3	2.8	3.05	1798	92
*362.5	355L2A	351501-**C	3580	94.1	0.905	534	6.9	967	2.0	2.8	3.6	2158	92

460V 60Hz													
功率 Output kW	型号规格 Type designation	产品代码 Product code	转速 Speed n r/min	效率 Efficiency Full load 100%η	功率因数 Power factor cosφ	电流 Current		转矩 Torque			转动惯量 Moment of inertia J=GD <sup>2</sup> /4 Kgm <sup>2</sup>	重量 Weight kg	噪声 Sound pressure level Lp dB(A)
						额定电流 I <sub>N</sub> A	堵转电流 I <sub>s</sub> /I <sub>N</sub>	额定转矩 T <sub>N</sub> Nm	堵转转矩 T <sub>s</sub> /T <sub>N</sub>	最大转矩 T <sub>MAX</sub> /T <sub>N</sub>			
1800r/min=4 poles Basic design													
0.63	M2JA 80M4A 3GJA	082301-**C	1695	73.5	0.73	1.47	5.2	3.55	2.4	2.0	0.00145	30	49
0.86	80M4B	082302-**C	1690	78.0	0.75	1.85	6.0	4.86	2.4	2.2	0.00174	31	49
1.27	90S4A	092101-**C	1695	79.0	0.765	2.64	6.0	7.16	2.3	2.2	0.00254	34	55
1.73	90L4A	092501-**C	1700	81.5	0.785	3.39	6.0	9.70	2.3	2.2	0.00317	41	55
2.53	100L4A	102501-**C	1730	83.0	0.795	4.81	6.0	14.0	2.3	2.2	0.00679	45	56
3.45	100L4B	102502-**C	1725	85.0	0.815	6.25	6.5	19.1	2.3	2.2	0.00862	52	56
4.60	112M4A	112301-**C	1735	87.0	0.785	8.45	6.5	25.3	2.3	2.2	0.01306	64	59
6.33	132S4A	132101-**C	1735	87.0	0.82	11.1	6.5	34.8	2.3	2.2	0.02673	81	62
8.6	132M4A	132301-**C	1735	87.5	0.83	14.9	6.5	47.3	2.3	2.2	0.03432	94	62
12.7	160M4A	162301-**C	1755	88.5	0.87	20.7	6.5	69.1	2.4	2.8	0.06543	152	69
17.3	160L4A	162501-**C	1750	90.5	0.88	27.3	6.5	94.4	2.3	2.4	0.09349	181	69
21.3	180M4A	182301-**C	1770	91.0	0.865	34.0	6.5	115	2.3	3.0	0.16049	214	69
25.3	180L4A	182501-**C	1770	91.0	0.88	39.7	6.5	137	2.4	3.1	0.18046	232	69
34.5	200L4A	202501-**C	1775	92.4	0.875	53.6	6.5	186	2.2	2.8	0.2819	312	74
42.6	225S4A	222101-**C	1780	93.0	0.87	66.1	7.0	229	2.2	2.8	0.37	358	76
51.8	225M4A	222301-**C	1780	93.0	0.86	81.3	7.0	278	2.2	2.8	0.42	396	76
63	250M4A	252301-**C	1775	93.0	0.885	96.1	7.0	339	2.4	3.0	0.78	563	79
86	280S4A	282101-**C	1780	93.2	0.885	131	6.5	461	2.4	2.6	1.10	668	81
104	280M4A	282301-**C	1780	93.5	0.895	156	7.2	558	2.3	2.8	1.35	740	81
127	315S4A	312101-**C	1780	93.5	0.875	195	6.9	681	2.1	2.2	2.8596	1163	83
152	315M4A	312301-**C	1780	94.5	0.88	229	6.9	816	2.1	2.2	3.1848	1288	83
* 184	315L4A	312501-**C	1780	94.5	0.875	279	6.9	987	2.1	2.2	3.6765	1313	89
* 230	315L4B	312502-**C	1780	94.5	0.885	345	6.9	1234	2.1	2.2	4.2516	1375	89
*287.5	355M4A	352301-**C	1785	94.5	0.905	422	6.9	1538	2.1	2.6	6.77	1933	90
*362.5	355L4A	352501-**C	1785	94.5	0.905	532	7.0	1934	2.1	2.3	8.20	2275	90

\*Insulation Class F Temperature rise Class F

D	S	
380~420VΔ50Hz	220~240VΔ50Hz	其他电压频率(最大值, 690V)可通过添加VC002, VC209实现。(VC定义请见后页VC适用表) Other rated voltage connection or frequency(Max,690V)can be used with VC002 or VC209.(The meaning of Variet code can be referred to Variant Code List)
660~690VY50Hz	380~420VY50Hz	
440~480 <sup>1)</sup> VΔ60Hz	440~480VY60Hz	
<sup>1)</sup> 480V not stamped on sizes 160 to 355		

460V 60Hz													
功率 Output kW	型号规格 Type designation	产品代码 Product code	转速 Speed n r/min	效率 Efficiency Full load 100%η	功率因数 Power factor cosφ	电流 Current		转矩 current			转动惯量 Moment of inertia J=GD <sup>2</sup> /4 KgM <sup>2</sup>	重量 Weight kg	噪声 Sound pressure level Lp dB(A)
						额定电流 I <sub>N</sub> A	堵转电流 I <sub>s</sub> /I <sub>N</sub>	额定转矩 T <sub>N</sub> Nm	堵转转矩 T <sub>s</sub> /T <sub>N</sub>	最大转矩 T <sub>MAX</sub> /T <sub>N</sub>			
1200r/min=6 poles Basic design													
0.43	M2JA 80M6A3GJA	083301-**C	1105	66.3	0.66	1.23	5.0	3.72	1.9	1.9	0.00159	31	48
0.63	80M6B	083302-**C	1115	68.0	0.665	1.75	5.0	5.40	1.9	1.9	0.00196	32	48
0.86	90S6A	093101-**C	1115	73.0	0.72	2.05	5.0	7.37	2.0	2.2	0.00292	34	51
1.27	90L6A	093501-**C	1110	75.0	0.72	2.95	5.0	10.9	2.0	2.2	0.00379	41	51
1.73	100L6A	103501-**C	1135	77.0	0.745	3.79	5.5	14.6	2.0	2.2	0.00999	45	54
2.53	112M6A	113301-**C	1140	78.5	0.735	5.50	5.5	21.2	2.0	2.2	0.01559	59	57
3.45	132S6A	133101-**C	1145	83.5	0.77	6.73	6.5	28.8	2.0	2.2	0.03116	76	59
4.60	132M6A	133301-**C	1150	85.0	0.77	8.82	6.5	38.2	2.0	2.2	0.04074	86	59
6.33	132M6B	133302-**C	1150	85.0	0.78	12.0	6.58	52.6	2.0	2.2	0.05332	96	59
8.6	160M6A	163301-**C	1165	86.0	0.78	16.1	6.0	70.5	2.0	2.3	0.09231	153	64
12.7	160L6A	163501-**C	1165	89.0	0.785	22.8	6.0	104	2.2	2.3	0.12970	181	65
17.3	180L6A	183501-**C	1175	90.2	0.83	29.0	6.0	141	2.3	2.8	0.2418	225	66
21.3	200L6A	203501-**C	1175	91.0	0.83	35.4	6.0	173	2.2	2.8	0.34174	294	67
25.3	200L6B	203502-**C	1175	91.0	0.84	41.5	6.0	206	2.1	2.8	0.46837	308	67
34.5	225M6A	223301-**C	1185	91.7	0.825	57.2	6.6	278	2.2	2.8	0.62691	385	69
42.6	250M6A	253301-**C	1175	91.7	0.88	66.3	6.8	345	2.3	2.8	0.97	478	71
51.8	280S6A	283101-**C	1185	92.1	0.88	80.2	6.2	419	2.3	2.4	1.25	603	72
63	280M6A	283301-**C	1185	92.1	0.88	97.6	7.0	510	2.3	2.5	1.485	665	73
86	315S6A	313101-**C	1185	93.0	0.865	134	7.4	693	2.0	2.0	3.1942	1150	78
104	315M6A	313301-**C	1185	94.1	0.865	160	7.4	838	2.0	2.0	3.723	1263	73
127	315L6A	313501-**C	1185	94.1	0.875	194	6.8	1024	2.0	2.0	4.2564	1325	73
152	315L6B	313502-**C	1185	94.1	0.88	230	6.8	1225	2.0	2.0	5.1577	1400	73
* 184	355M6A	353301-**C	1190	94.1	0.88	279	6.8	1477	2.1	2.4	7.8	1700	78
* 230	355M6B	353302-**C	1190	94.1	0.885	347	6.7	1846	2.0	2.3	9.1	1939	78
*287.5	355L6A	353501-**C	1190	94.1	0.885	433	6.7	2307	2.0	2.3	11.4	2571	78

460V 60Hz													
功率 Output kW	型号规格 Type designation	产品代码 Product code	转速 Speed n r/min	效率 Efficiency Full load 100%η	功率因数 Power factor cosφ	电流 Current		转矩 current			转动惯量 Moment of inertia J=GD <sup>2</sup> /4 Kgm <sup>2</sup>	重量 Weight kg	噪声 Sound pressure level Lp dB(A)
						额定电流 I <sub>N</sub> A	堵转电流 I <sub>s</sub> /I <sub>N</sub>	额定转矩 T <sub>N</sub> Nm	堵转转矩 T <sub>s</sub> /T <sub>N</sub>	最大转矩 T <sub>MAX</sub> /T <sub>N</sub>			
900r/min=8 poles Basic design													
0.86	M2JA 100L8A3GJA	104501-**C	840	72.0	0.64	2.34	5.0	9.78	1.8	2.0	0.00971	44	56
1.27	100L8B	104502-**C	830	72.8	0.645	3.39	5.0	14.6	1.8	2.0	0.01186	50	56
1.73	112M8A	114301-**C	845	76.4	0.675	4.21	5.0	19.6	1.8	2.0	0.1559	61	58
2.53	132S8A	134101-**C	860	80.7	0.73	5.39	5.5	28.1	1.8	2.0	0.03625	77	58
3.45	132M8A	134301-**C	855	81.8	0.755	7.01	5.5	38.5	1.8	2.0	0.04141	85	59
4.60	160M8A	164301-**C	865	84.0	0.75	9.16	5.5	50.8	2.1	2.5	0.0676	139	61
6.33	160M8A	164302-**C	865	84.9	0.76	12.3	5.5	69.9	2.1	2.5	0.09524	151	61
8.6	160L8A	164501-**C	865	85.2	0.77	16.5	5.5	94.9	2.1	2.5	0.12122	177	61
12.7	180L8A	184501-**C	880	88.8	0.775	23.2	5.4	138	2.0	2.8	0.23645	222	64
17.3	200L8A	204501-**C	880	89.7	0.785	30.8	5.5	188	2.3	2.8	0.37103	308	66
21.3	225S8A	224101-**C	885	90.2	0.745	39.8	5.5	230	2.1	2.8	0.53287	341	68
25.3	225M8A	224301-**C	885	90.4	0.75	46.8	6.0	273	2.2	2.8	0.65825	383	68
34.5	250M8A	254301-**C	880	91.6	0.80	59.1	6.5	374	2.3	2.6	0.975	490	70
42.6	280S8A	284101-**C	885	91.2	0.805	72.8	6.0	460	2.1	2.6	1.25	610	71
51.8	280M8A	284301-**C	885	92.0	0.805	87.8	6.0	559	2.1	2.7	1.485	685	71
63	315S8A	314101-**C	885	92.6	0.825	104	6.9	676	1.8	2.0	3.6842	1163	68
86	315M8A	314301-**C	890	93.1	0.825	141	7.0	923	1.8	2.0	4.9591	1263	71
104	315L8A	314501-**C	890	93.7	0.825	169	7.1	1116	1.8	2.0	5.8205	1338	71
127	315L8A	314502-**C	885	94.2	0.83	204	6.4	1363	1.8	2.0	6.7537	1425	71

\*Insulation Class F Temperature rise Class F

D	S	
380~420V△50Hz	220~240V△50Hz	其他电压频率(最大值, 690V) 可通过添加VC002, VC209实现。(VC定义请见后页VC适用表) Other rated voltage connection or frequency(Max,690V) can be used with VC002 or VC209.(The meaning of Variet code can be referred to Variant Code List)
660~690VY50Hz	380~420VY50Hz	
440~480 <sup>1)</sup> V△60Hz	440~480VY60Hz	
<sup>1)</sup> 480V not stamped on sizes 160 to 355		

# 电动机外形图 Dimension Drawing

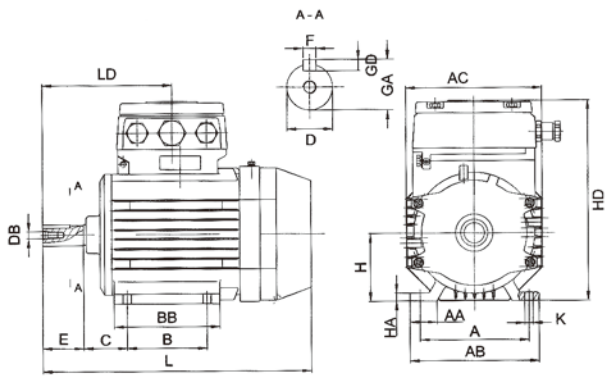

M2JA80-132

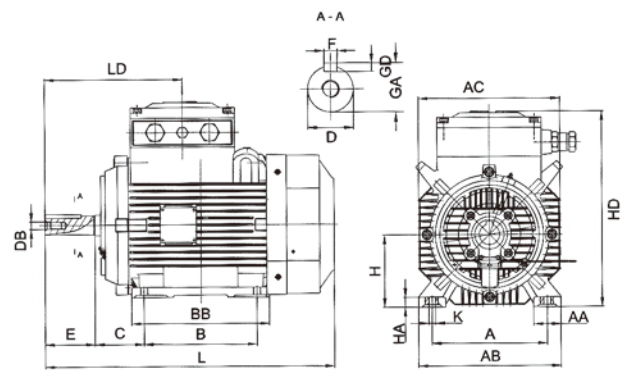

M2JA160-355

## IMB3 (IM1001)

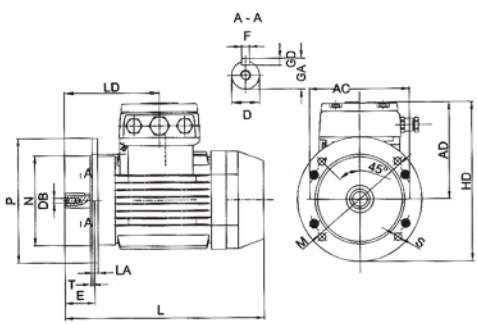

M2JA80-132

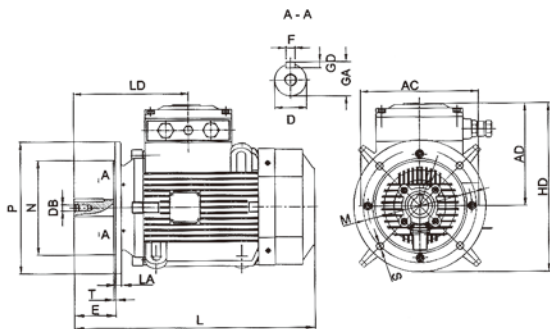

M2JA160-200

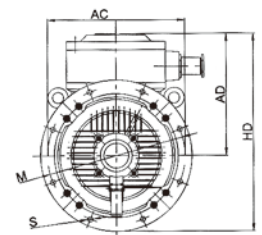

M2JA225-355

## IMB5 (IM3001)

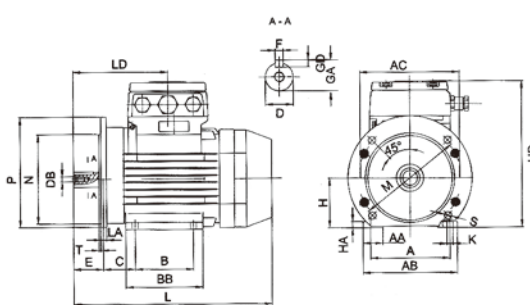

M2JA80-132

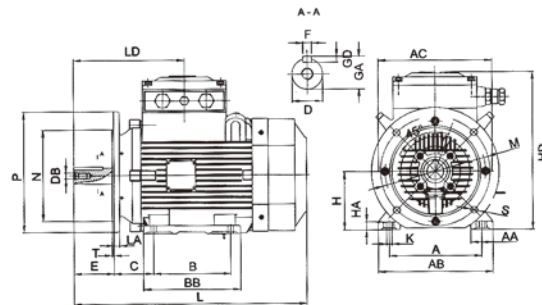

M2JA160-200

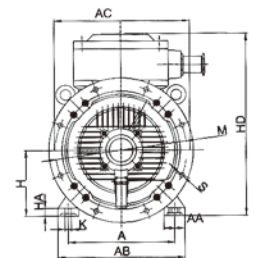

M2JA225-355

## IMB35 (IM2001)

Type	Poles	A	AA	AB	AC	B	BB	C	D	E	F	GA	GD	H	HA	HD	K	L	LD	AD	LA	M	N	P	S	T	DB	EG
80M	2-8	125	35	160	165	100	135	50	19	40	6	21.5	6	80	12	260	10	340	155	180	12	165	130	200	12	3.5	M6	16
90S	2-8	140	35	175	180	100	140	56	24	50	8	27	7	90	12	275	10	355	165	181	12	165	130	200	12	3.5	M8	19
90L	2-8	140	35	175	180	125	165	56	24	50	8	27	7	90	12	275	10	380	165	181	12	165	130	200	12	3.5	M8	19
100L	2-8	160	40	200	205	140	180	63	28	60	8	31	7	100	14	300	12	450	190	195	11	215	180	250	15	4	M10	22
112M	2-8	190	50	235	225	140	190	70	28	60	8	31	7	112	15	320	12	490	205	202	11	215	180	250	15	4	M10	22
132S	2-8	216	55	270	265	140	205	89	38	80	10	41	8	132	18	360	12	485	225	220	12	265	230	300	15	4	M12	28
132M	2-8	216	55	270	265	178	240	89	38	80	10	41	8	132	18	360	12	520	225	220	12	265	230	300	15	4	M12	28
160M	2-8	254	60	325	330	210	270	108	42	110	12	45	8	160	22	450	15	650	305	285	15	300	250	350	19	5	M16	36
160L	2-8	254	60	325	330	254	315	108	42	110	12	45	8	160	22	450	15	690	305	285	15	300	250	350	19	5	M16	36
180M	2-4	279	70	355	355	241	315	121	48	110	14	51.5	9	180	22	480	15	725	315	295	18	300	250	350	19	5	M16	36
180L	4-8	279	70	355	355	279	355	121	48	110	14	51.5	9	180	22	480	15	765	315	295	18	300	250	350	19	5	M16	36
200L	2-8	318	70	390	395	305	395	133	55	110	16	59	10	200	25	610	19	815	365	404	20	350	300	400	19	5	M20	39
225S	4-8	356	75	435	440	286	380	149	60	140	18	64	11	225	28	650	19	845	395	421	20	400	350	450	19	5	M20	39
225M	2	356	75	435	440	311	405	149	55	110	16	59	10	225	28	650	19	840	365	421	20	400	350	450	19	5	M20	39
225M	4-8	356	75	435	440	311	405	149	60	140	18	64	11	225	28	650	19	870	395	421	20	400	350	450	19	5	M20	39
250M	2	406	80	490	515	349	475	168	60	140	18	64	11	250	30	700	24	970	420	447	22	500	450	550	19	5	M20	39
250M	4-8	406	80	490	515	349	475	168	65	140	18	69	11	250	30	700	24	970	420	447	22	500	450	550	19	5	M20	39
280S	2	457	85	550	555	368	490	190	65	140	18	69	11	280	35	750	24	1030	450	470	22	500	450	550	19	5	M20	39
280S	4-8	457	85	550	555	368	490	190	75	140	20	79.5	12	280	35	750	24	1030	450	470	22	500	450	550	19	5	M20	39
280M	2	457	85	550	555	419	540	190	65	140	18	69	11	280	35	750	24	1080	450	470	22	500	450	550	19	5	M20	39
280M	4-8	457	85	550	555	419	540	190	75	140	20	79.5	12	280	35	750	24	1080	450	470	22	500	450	550	19	5	M20	39
315S	2	508	120	640	630	406	575	216	65	140	18	69	11	315	45	1010	28	1240	440	685	24	600	550	660	24	6	M20	42
315S	4-8	508	120	640	630	406	575	216	80	170	22	85	14	315	45	1010	28	1240	470	685	24	600	550	660	24	6	M20	42
315M	2	508	120	640	630	457	685	216	65	140	18	69	11	315	45	1010	28	1380	440	685	24	600	550	660	24	6	M20	42
315M	4-8	508	120	640	630	457	685	216	80	170	22	85	14	315	45	1010	28	1380	470	685	24	600	550	660	24	6	M20	42
315L	2	508	120	640	630	508	685	216	65	140	18	69	11	315	45	1010	28	1380	440	685	24	600	550	660	24	6	M20	42
315L	4-8	508	120	640	630	508	685	216	80	170	22	85	14	315	45	1010	28	1380	470	685	24	600	550	660	24	6	M20	42
355M	2	610	120	735	710	560	755	254	70	140	20	74.5	12	355	52	1080	35	1550	470	695	25	600	680	800	24	6	M20	42
355M	4-6	610	120	735	710	560	755	254	100	210	28	106	16	355	52	1080	35	1620	540	695	25	600	680	800	24	6	M24	47
355L	2	610	120	735	710	630	755	254	70	140	20	74.5	12	355	52	1080	35	1550	470	695	25	600	680	800	24	6	M20	42
355L	4-6	610	120	735	710	630	755	254	100	210	28	106	16	355	52	1080	35	1620	540	695	25	600	680	800	24	6	M24	47

## 电动机外形图 Dimension Drawing

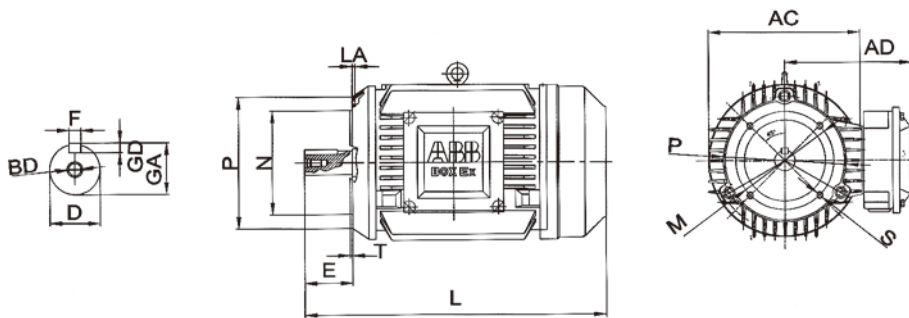

IMB14 (IM3601)

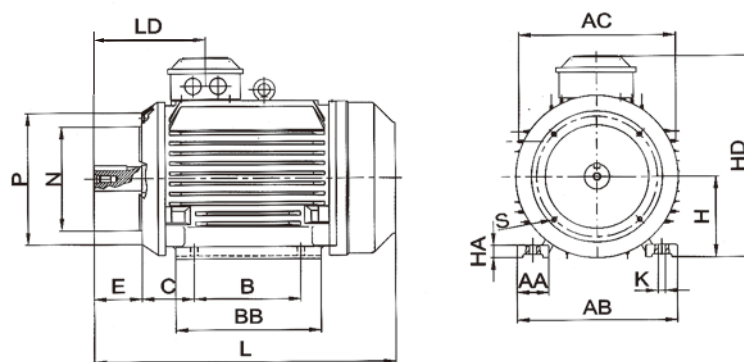

IMB34 (IM2101)

Type	Poles	A	AA	AB	AC	B	BB	C	D	E	F	GA	GD	H	HA	HD	K	L	LD	AD	LA	HE	DB	EG
80M	2-8	125	35	160	165	100	135	50	19	40	6	21.5	6	80	12	260	10	340	155	145	9	200	M6	16
90S	2-8	140	35	175	180	100	140	56	24	50	8	27	7	90	12	275	10	355	165	150	10	200	M8	19
90L	2-8	140	35	175	180	125	165	56	24	50	8	27	7	90	12	275	10	380	165	150	10	200	M8	19
100L	2-8	160	40	200	205	140	180	63	28	60	8	31	7	100	14	300	12	450	190	175	11	270	M10	22
112M	2-8	190	50	235	225	140	190	70	28	60	8	31	7	112	15	320	12	490	205	185	11	278	M10	22
132S	2-8	216	55	270	265	140	205	89	38	80	10	41	8	132	18	360	12	485	205	220	15	320	M12	28
132M	2-8	216	55	270	265	178	240	89	38	80	10	41	8	132	18	360	12	520	225	220	15	320	M12	28
160M	2-8	254	60	325	330	210	270	108	42	110	12	45	8	160	22	450	15	650	305	285	20	400	M16	36
160L	2-8	254	60	325	330	254	315	108	42	110	12	45	8	160	22	450	15	690	305	285	20	400	M16	36

Type	Poles	size	P	M	N	S	T
80M	2-8	C120	120	100	80	M6	3
80M	2-8	C160	160	130	110	M8	3.5
90S	2-8	C140	140	115	95	M8	3
90S	2-8	C160	160	130	110	M8	3.5
90L	2-8	C140	140	115	95	M8	3
90L	2-8	C160	160	130	110	M8	3.5
100L	2-8	C160	160	130	110	M8	3.5
100L	2-8	C200	200	165	130	M10	3.5
112M	2-8	C160	160	130	110	M8	3.5
112M	2-8	C200	200	165	130	M10	3.5
132S	2-8	C200	200	165	130	M10	3.5
132M	2-8	C200	200	165	130	M10	3.5
160M	2-8	C250	250	215	180	M12	4
160L	2-8	C250	250	215	180	M12	4

## 中外隔爆电机等级的分类

### Chines & International Specifications of Explosion

使用场所 Location	标准代号 Code of Standard		
	GB1336-77	GB3836.1-2-IEC60079-1	CENELEC EN60079-1
	隔爆等级 flameproof class		
矿用 For Mines	KB	d I	d I
其它工业用 For other Industries	B1	d II A	d II A
	B2	d II A	d II A
	B3	d II B	d II B
	B4	d II C	d II C

## 外壳的类别所对应的各种可燃性气体或蒸汽及其分组

### To Show the Group of Enclosures Suitable For a Particular Flammable Gas or Vapour and Its Classification

外壳等级 Group of enclosure	按爆炸性混合物的自然温度(°C)分组 Temp.class				
	T1	T2	T3	T4	T6
	可燃性气体或气 Flammable gas or vapour				
I	甲烷 Methane 氨 Ammonia 醋酸 Acetic acid	丁醇 Butyl alcohol 醋酸酐 Acetic anhydride	环己烷 Cyclohexane		
II A	乙烷 Ethane 丙烷 Propane 丙酮 Acetone 苯乙烯 Styrene 苯 Benzene 氯苯 Chlorobenzene 甲醇 Methanol 甲苯 Toluene 一氧化碳 Carbonmonoxide	丁烷 Butane 乙醇 Ethanol 丙烯 Propene 醋酸丁酯 n-Butyl acetate 醋酸戊酯 Amyl acetate 氯乙烯 Chloroethylene 醋酸乙酯 Ethyl acetate	戊烷 Pentane 乙烷 Hexane 庚烷 Heptane 辛烷 Octane 癸烷 Decane 硫化氢 Hydrosulxide 汽油 Gasoline	乙醚 Ether 乙醛 Acetaldeh yde	
II B	氰化氢 Hydrogen cyanide 焦炉煤气 Coal gas	环氧乙烷 Ethylene oxide 丁二烯 Butadiene 1,4-二氧基己烷 1,4-dioxan 乙烯 Ethyene	异戊二烯 Isopentylens 二甲醚 Dimethylether 丁烯醛 Butenal 乙硫醇 Ethanethiol	乙基甲基醚 Ethyl methyl ether 二乙醚 Ethyl oxide 二丁醚 Butyl oxide 四氟乙烯 Tetrafluoroethylene	
II C	水煤气 Water gas 氢 Hydrogen	乙炔 Acetylene			二硫化碳 Carbon disulfide

## 点燃组别的分类

### Specifications of Ignition Group for Flameproof Motors

GB3836.1、IEC60079-0、EN60079-0	
组别 Ignition group	点燃温度℃ Ignition temperature
T1	450
T2	300
T3	200
T4	135
T5	100
T6	85

## 隔爆级组及其选用

### Selection of Flameproof Motors from Type of Enclosure and Temp.Class

选用电动机时，必须根据环境中爆炸性混合物的级、组来确定。当环境中含多种爆炸性混合物时，须按级别与组别最高者选用。

- I 适用于有爆炸性混合物存在的地下煤矿和工厂。
- II A T4 适用于工厂为A类，温度组别为T1~T4组的爆炸性气体环境。
- II B T4 适用于工厂为B类，温度组别为T1~T4组的爆炸性气体环境。
- II C T4 适用于工厂为C类，温度组别为T1~T4组的爆炸性气体环境。

Selection of a motor should be according to the group of explosive mixture and the temp.class.existed in the location. if the location contains several groups of explosive mixtures, the selection should be according to the highest group and temp.class.

- I :Suitable for underground coal mines and locations where explosive mixtures classified in group exist.
- II A T4: Suitable for factory where explosive gas atmosphere in Group II A and temp.classes T1-T4 exist.
- II B T4: Suitable for factory where explosive gas atmosphere in Group II B and temp.classes T1-T4 exist.
- II C T4: Suitable for factory where explosive gas atmosphere in Group II C and temp.classes T1-T4 exist.

## ATEX Ex 证书对照表

### Ex certificate(ATEX)

ATEX Certificate No.	Marking	Covered product range	Rated voltage
LCIE 04 ATEX6095	Ex d IIC T1 to T5 CE0081  II 2G	M2JA80M2,4,6A M2JA80M2,4,6B	220~240V, 380~420V, 50Hz 440~480V, 60Hz
LCIE 04 ATEX6096		M2JA90S2,4,6A M2JA90L2,4,6A	
LCIE 04 ATEX6097		M2JA100L2,4,6,8A M2JA100L4,8B	
LCIE 04 ATEX6098		M2JA112M2,4,6,8A	220~240V, 380~420V, 660~690V, 50Hz 440~480V, 60Hz
LCIE 04 ATEX6099		M2JA132S2,4,6,8A M2JA132S2B M2JA132M4,6,8A M2JA132M6B	
LCIE 04 ATEX6100		M2JA160M2,4,6,8A M2JA160M2,8B M2JA160L2,4,6,8A	
LCIE 04 ATEX6101		M2JA180M2,4A M2JA180L4,6,8A	380~420V, 660~690V, 50Hz 440~480V, 60Hz
LCIE 04 ATEX6102		M2JA200L2,4,6,8A M2JA200L2,6B	
LCIE 04 ATEX6103		M2JA225S4,8A M2JA225M2,4,6,8A	
LCIE 04 ATEX6104		M2JA250M2,4,6,8A	
LCIE 04 ATEX6105		M2JA280S2,4,6,8A M2JA280M2,4,6,8A	
LCIE 04 ATEX6106		M2JA315S2,4,6,8A M2JA315M2,4,6,8A M2JA315L2,4,6,8A M2JA315L2,4,6,8B	
LCIE 04 ATEX6107		M2JA355M2,4,6A M2JA355M6B M2JA355L2,4,6A	



## M2JA系列三相异步电动机变量代码(简称M2JA-VC) M2JA Motor's Variant Code

代码/Code	变量/Variant	Frame Size													
		80	90	100	112	132	160	180	200	225	250	280	315	355	
管理/Administration															
531	海运包装 Sea freight packing	NA	NA	NA	NA	NA	P	P	P	P	P	P	P	P	P
平衡/Balancing															
423	无键平衡 Balanced without key.	P	P	P	P	P	P	P	P	P	P	P	P	P	P
424	全键平衡 Full key balancing.	P	P	P	P	P	P	P	P	P	P	P	P	P	P
轴承与润滑/Bearings and Lubrication															
039	耐低温油脂 Cold resistant grease.	P	P	P	P	P	P	P	P	P	P	P	P	P	P
040	耐高温油脂 Heat resistant grease.	P	P	P	P	P	P	P	P	P	P	P	P	P	P
041	通过注油孔对轴承加油 Bearings regreasable via grease nipples.	NA	NA	NA	NA	NA	S	S	S	S	S	S	S	S	S
043	SPM震动测量接头 SPM compatible nipples for vibration measurement.	NA	NA	NA	NA	NA	P	P	P	P	P	P	P	P	P
195	全封闭轴承 Bearings greased for life.	S	S	S	S	S	NA	NA	NA	NA	NA	NA	NA	NA	NA
798	不锈钢注油嘴 Stainless steel grease nipples.	NA	NA	NA	NA	NA	P	P	P	P	P	P	P	P	P
部门标准设计/Branch standard designs															
168	仅涂底漆 Primer paint only.	P	P	P	P	P	P	P	P	P	P	P	P	P	P
396	用于环境温度-20°C~-40°C 的电机, 带空间加热带 (代码450/451必须) Motor designed for ambient temperature -20°C~-40°C, with space heaters(code 450/451 must be added).	P	P	P	P	P	P	P	P	P	P	P	P	P	P
425	防腐蚀定子和转子 Corrosion protected stator and rotor core.	P	P	P	P	P	P	P	P	P	P	P	P	P	P
文件材料/Documentation															
141	配外形图 Binding dimension drawing.	P	P	P	P	P	P	P	P	P	P	P	P	P	P
接地螺栓/Earthing Bolt															
067	外部接地螺栓 External earthing bolt.	S	S	S	S	S	S	S	S	S	S	S	S	S	S
加热元件/Heating elements															
450	加热带100-120V Heating elements,100-120V	P	P	P	P	P	P	P	P	P	P	P	P	P	P
451	加热带200-240V Heating elements,200-240V	P	P	P	P	P	P	P	P	P	P	P	P	P	P
安装方式/Mounting agrangements															
008	IM2101底脚/法兰安装, IEC法兰, 由IM1001派生 (B3派生出B34) IM2101 foot/flange mounted, IEC flange,from IM1001 (B34 from B3)	P	P	P	P	P	P	NA	NA	NA	NA	NA	NA	NA	NA

S=在标准情况下包含  
R=根据需要, 技术确认  
NA=不适用  
P=根据需要, 直接排产

S=Included as standard  
R=On request  
NA=Not applicable  
P=Applicable

## M2JA系列三相异步电动机变量代码(简称M2JA-VC) M2JA Motor's Variant Code

代码/Code	变量/Variant	Frame Size												
		80	90	100	112	132	160	180	200	225	250	280	315	355
安装方式/Mounting arrangements														
009	IM2001底脚/法兰安装, IEC 法兰, 由IM1001派生 (B3派生出B35) IM2001 foot/flange mounted, IEC flange, from IM1001 (B35 from B3)	P	P	P	P	P	P	P	P	P	P	P	P	P
047	IM3601法兰安装, IEC法兰, 由IM3001派生 (B5派生出B14) IM3601 flange mounted, IEC flange, from IM3001 (B14 from B5)	P	P	P	P	P	P	NA	NA	NA	NA	NA	NA	NA
066 <sup>1)</sup>	非标安装方式 (请指定IM xxx) (除B3 (1001)、B5 (30010、B14 (3601)、IM B35 (2001) & IM B34) (2101)外的其它安装型式须在定单中注明 Modified for specified mounting position differing from IM B3(1001), IM B5 (3001.), B14(3601), IM B35 (2001) & IM B34)	P	P	P	P	P	P	P	P	P	P	P	P	P
999	大法兰 (C***) B14 big flange	P	P	P	P	NA	NA	NA	NA	NA	NA	NA	NA	NA
喷漆/Painting														
114	特殊油漆颜色, 标准等级 Special paint colour, standard grade.	R	R	R	R	R	R	R	R	R	R	R	R	R
106	喷涂厚度=80µm Paint thickness =80µm.	S	S	S	S	S	S	S	S	S	S	S	S	S
109	喷涂厚度=120µm Paint thickness =120µm.	R	R	R	R	R	R	R	R	R	R	R	R	R
110	喷涂厚度=160µm Paint thickness =160µm.	R	R	R	R	R	R	R	R	R	R	R	R	R
防护/Protection														
005	金属防雨罩, 立式电机, 轴伸向下 Metal protective roof, vertical motor, shaft down.	P	P	P	P	P	P	P	P	P	P	P	P	P
072	D端径向密封 Radial seal at D-end.	S	S	S	S	S	S	S	S	S	S	S	S	S
铭牌和指示牌/Rating & instuction plates														
002	重敲铭牌电压、频输出、连续工作制 Restamping voltage, frequency and output, continuous duty.	R	R	R	R	R	R	R	R	R	R	R	R	R
135	安装额外不锈钢指示牌 Mounting of additional identification plate, stainless.	P	P	P	P	P	P	P	P	P	P	P	P	P
139	附加指示牌, 单独交付 Additional identification plate, stainless	P	P	P	P	P	P	P	P	P	P	P	P	P

注释/Note:

1) 安装型为: B6、B7、B8、V1、V15、V3、V35、V5、V6 (H250以上仅限V1、V15)

1) Mounting arrangements: B6、B7、B8、V1、V15、V3、V35、V5、V6 (Only V1、V15 for H250 and above)

S=在标准情况下包含  
R=根据需要, 技术确认  
NA=不适用  
P=根据需要, 直接排产

S=Included as standard  
R=On request  
NA=Not applicable  
P=Applicable

## M2JA系列三相异步电动机变量代码(简称M2JA-VC) M2JA Motor's Variant Code

代码/Code	变量/Variant	Frame Size												
		80	90	100	112	132	160	180	200	225	250	280	315	355
轴和转子/Shaft & rotor														
069	标准双出轴 Two shaft extension as per basic catalogue.	R	R	R	R	R	R	NA	NA	NA	NA	R	NA	NA
070	D端特殊轴伸, 标准材料 Special shaft extension at D-end, standard shaft material.	R	R	R	R	R	R	R	R	R	R	R	R	R
164	闭口键槽轴伸 Shaft extension with closed key-way.	P	P	P	P	P	P	P	P	P	P	P	P	P
165	开口键槽轴伸 Shaft extension with open key-way.	S	S	S	S	S	S	S	S	S	S	S	S	S
标准和规范/Standards and Regulations														
115	符合ISO 12944-5:2007的喷漆系统C4M Painting system C4M acc. To ISO 12944-5:2007.	R	R	R	R	R	R	R	R	R	R	R	R	R
754	符合ISO 12944-5:2007的喷漆系统C5M Painting system C5M acc. To ISO 12944-5:2007.	R	R	R	R	R	R	R	R	R	R	R	R	R
定子绕组温度传感器/Stator winding temperature sensors														
435	定子绕组安装PTC-热敏电阻(3个串联), 130°C PTC-thermistors(3 in series), 130°C in stator winding.	P	P	P	P	P	P	P	P	P	P	P	P	P
436	定子绕组安装PTC-热敏电阻(3个串联), 150°C PTC-thermistors(3 in series), 150°C in stator winding.	P	P	P	P	P	P	P	P	P	P	P	P	P
439	定子绕组安装PTC-热敏电阻(2×3个串联), 150°C PTC-thermistors(2×3 in series), 150°C, in stator winding.	P	P	P	P	P	P	P	P	P	P	P	P	P
440	定子绕组安装PTC-热敏电阻(3个串联, 110°C以及3个串联, 130°C) PTC-thermistors(3 in series 110°C & 3 in series 130°C), in stator winding.	P	P	P	P	P	P	P	P	P	P	P	P	P
441	定子绕组安装PTC-热敏电阻(3个串联, 130°C以及3个串联, 150°C) PTC-thermistors(3 in series 130°C & 3 in series 150°C), in stator winding.	P	P	P	P	P	P	P	P	P	P	P	P	P
445	定子绕组安装PT100(2线), 每相1个 PT100 2-wire in stator winding, 1 per phase.	P	P	P	P	P	P	P	P	P	P	P	P	P
446	定子绕组安装PT100(2线), 每相2个 PT100 2-wire in stator winding, 2 per phase.	NA	NA	NA	NA	NA	P	P	P	P	P	P	P	P
502	定子绕组安装PT100(3线), 每相1个 PT100 3-wire in stator winding, 1 per phase.	NA	NA	NA	NA	NA	P	P	P	P	P	P	P	P
503	定子绕组安装PT100(3线), 每相2个 PT100 3-wire in stator winding, 2 per phase.	NA	NA	NA	NA	NA	NA	NA	NA	NA	P	P	P	P

S=在标准情况下包含  
R=根据需要, 技术确认  
NA=不适用  
P=根据需要, 直接排产

S=Included as standard  
R=On request  
NA=Not applicable  
P=Applicable

## M2JA系列三相异步电动机变量代码(简称M2JA-VC) M2JA Motor's Variant Code

代码/Code	变量/Variant	Frame Size												
		80	90	100	112	132	160	180	200	225	250	280	315	355
接线盒/Terminal box														
022	电缆进线孔在左侧(从D端看) Cable entry LHS(see from D-end).	P	P	P	P	P	P	P	P	P	P	P	P	P
400	4×90度可转动的接线盒 4×90 degr turnable terminal box.	S	S	S	S	S	S	S	S	S	S	S	S	S
468	电缆进线孔朝D端 Cable entry from D-end.	R	R	R	R	R	R	R	R	R	R	R	R	R
469	电缆进线孔朝N端 Cable entry from N-end.	R	R	R	R	R	R	R	R	R	R	R	R	R
230	标准金属电缆密封管 Standard metal cable glands.	S	S	S	S	S	NA	NA	NA	NA	NA	NA	NA	NA
731	2个标准金属电缆密封管 Two standard metal cable glands.	R	R	R	R	R	S	S	S	S	S	S	S	S
738	预留公制单位葛兰 Prepared for metric cable glands.	P	P	P	P	P	P	P	P	P	P	P	P	P
999	防爆管接头不锈钢ATEX Exd II C Standard stainless steel cable gland,ATEX Exd II C	P	P	P	P	P	P	P	P	P	P	P	P	P
999	防爆管接头不锈钢OSXP Exd II C Standard stainless steel cable gland,OSXP Exd II C	P	P	P	P	P	P	P	P	P	P	P	P	P
试验/Testing														
145	目录电机的型式试验报告, 400V 50HZ Type test report from a catalogue motor,400V 50HZ.	P	P	P	P	P	P	P	P	P	P	P	P	P
146	指定交货批次内的某一电机的型式试验及报告 Type test with report for one motor from special delivery batch.	P	P	P	P	P	P	P	P	P	P	P	P	P
147	指定交货批次内的某一电机的型式试验报告,客户现场见证 Type test with report for motor from special delivery batch, customer witnessed.	P	P	P	P	P	P	P	P	P	P	P	P	P
148	出厂试验报告 Routine test report.	P	P	P	P	P	P	P	P	P	P	P	P	P
221	指定交货批次的电机型式试验和多点负载测试,并提交报告 Type test and multi-point load test with report for one motor from specific delivery batch.	P	P	P	P	P	P	P	P	P	P	P	P	P
222	指定交货批次的一台电机转矩转速曲线、型式试验和多点负载测试,并提交报告 Type test and multi-point load test with report for one motor from specific delivery batch.	P	P	P	P	P	P	P	P	P	P	P	P	P
试验/Testing														
760	振动等级检测 Vibration level test.	P	P	P	P	P	P	P	P	P	P	P	P	P
762	对指定交货批次内的一台电机进行噪声等级测试 Noise level test for one motor from specific delivery batch.	P	P	P	P	P	P	P	P	P	P	P	P	P

S=在标准情况下包含  
R=根据需要,技术确认  
NA=不适用  
P=根据需要,直接排产

S=Included as standard  
R=On request  
NA=Not applicable  
P=Applicable

## 总部 Headquarter

ABB (中国) 有限公司 ABB (China) Ltd.  
中国北京市朝阳区酒仙桥路10号恒通大厦, 100016  
Universal Plaza, 10 Jiuxianqiao Lu, Chaoyang District,  
Beijing, 100016, P.R. China  
电话(Tel): +86 10 8456 6688  
传真(Fax): +86 10 8456 7613

## 销售机构 Sales Organizations

北京 Beijing  
中国北京市朝阳区酒仙桥路10号恒通大厦, 100016  
Universal Plaza, 10 Jiuxianqiao Lu, Chaoyang District,  
Beijing, 100016, P.R. China  
电话(Tel): +86 10 8456 6688  
传真(Fax): +86 10 8456 7613

## 长春 Changchun

中国吉林省长春市亚泰大街3218号通钢国际大厦A座  
A4层A401室, 130022  
Room A401, A4th floor, Tower A, Tisco International  
Mansion, 3218 Yatai Dajie, Changchun, Jilin, 130022,  
P.R. China  
电话(Tel): +86 431 862 0866  
传真(Fax): +86 431 862 0899

## 长沙 Changsha

中国湖南省长沙市黄兴中路88号平和堂商务楼  
12B01, 410005  
Suite 12B01, Ping He Tang Commercial Building, 88  
Huang Xing Middle Road, Changsha, Hu'nan,  
410005, P.R. China  
电话(Tel): +86 731 268 3088  
传真(Fax): +86 731 444 5519

## 成都 Chengdu

中国四川省成都市人民南路四段19号威斯頓联邦大厦  
10楼, 610041  
10th floor, Western Tower No.19 Section 4,  
Renminnan Road, Chengdu, Sichuan, 610041,  
P.R. China  
电话(Tel): +86 28 8526 8800  
传真(Fax): +86 28 8526 8900

## 重庆 Chongqing

中国重庆市南坪北路15号重庆扬子江假日饭店4楼,  
400060  
4/F, Yangtze Holiday Inn Chongqing No.15, Nan  
Ping Bei Road, Chongqing, 400060, P.R. China  
电话(Tel): +86 23 6282 6688  
传真(Fax): +86 23 6280 5369

## 大连 Dalian

中国辽宁省大连市西岗区中山路147号森茂大厦18楼,  
116011  
18/F Senmao Building, No.147, Zhongshan Road,  
Xigang District, Dalian, Liaoning, 116011, P.R. China  
电话(Tel): +86 411 8899 3355  
传真(Fax): +86 411 8899 3359

## 福州 Fuzhou

中国福建省福州市五四路158号环球广场30层3002室,  
350003  
Room 3002, 30F Worldwide Plaza, 158 Wusi Road,  
Fuzhou, Fujian, 350003, P.R. China  
电话(Tel): +86 591 8785 8224  
传真(Fax): +86 591 8781 4889

## 广州 Guangzhou

中国广东省广州市珠江新城临江大道3号发展中心大厦  
22楼, 510623  
22/F, Development Center, 3 Linjiang Dadao,  
Guangzhou, Guangdong, 510623, P.R. China.  
电话(Tel): +86 20 3785 0688  
传真(Fax): +86 20 3785 0608

## 杭州 Hangzhou

中国浙江省杭州市曙光路122号浙江世界贸易中心写  
字楼A座12楼, 310007  
12/F, Building A, Zhejiang World Trade Center Office  
Plaza, 122 ShuGuang Road, Hangzhou, Zhejiang,  
310007, P.R. China  
电话(Tel): +86 571 8790 1355  
传真(Fax): +86 571 8790 1151

## 哈尔滨 Harbin

中国黑龙江省哈尔滨市南岗区长江路99-9号辰能大  
厦14层, 150090  
14/F, ChengNeng Building No.99-9, Changjiang  
Road, NanGang District, Harbin, Heilongjiang,  
150090, P.R. China  
电话(Tel): +86 451 8287 6400  
传真(Fax): +86 451 8287 6404

## 合肥 Hefei

中国安徽省合肥市经济技术开发区繁华大道合肥索  
菲特明珠国际大酒店大厦壹楼, 230601  
1/F, Sofitel Grand Park Hotel Hefei, Hefei Economic  
& Technological Development Zone, Fanhua Road,  
Hefei, Anhui, 230601, P.R. China  
电话(Tel): +86 551 384 9700  
传真(Fax): +86 551 384 9707

## 呼和浩特 Huhhot

中国内蒙古自治区呼和浩特市新城区中山东路20  
号艾博科电大厦703室, 010020  
Room 703, AIBO e-Town Building, No. 20  
Zhongshan East Road, Xincheng District, Hohhot,  
Inner Mongolia, 010020, P.R. China  
电话(Tel): +86 471 693 1122  
传真(Fax): +86 471 691 6331

## 香港 Hong Kong

中国香港新界大埔工业村大喜街3号  
Tai Po Industrial Estate, 3 Dai Hei Street, Tai Po,  
NT, HK SAR, P.R. China  
电话(Tel): +852 2929 3838  
传真(Fax): +852 2929 3553

## 济南 Ji'nan

中国山东省济南市泉城路17号华能大厦8楼8801室,  
250011  
Room 8801, 8/F, Huaneng Building No. 17, Quan  
Cheng Road, Ji'nan, Shandong, P.R. China  
电话(Tel): +86 531 609 2726  
传真(Fax): +86 531 609 2724

## 昆明 Kunming

中国云南省昆明市青年路399号昆明年邦克饭店601  
室, 650011  
Room 601 Kunming Bank Hotel, 399 Youth Road,  
Kunming, Yunnan, 650011, P.R. China  
电话(Tel): +86 871 315 8188  
传真(Fax): +86 871 315 8186

## 南京 Nanjing

中国江苏省南京市中山东路90号华泰大厦17楼,  
210002  
17/F, Huatai Securities Mansion, No.90 East  
Zhongshan Road, Nanjing, Jiangsu, 210002, P.R. China  
电话(Tel): +86 25 8664 5645  
传真(Fax): +86 25 8664 5338

## 南宁 Nanning

中国广西省南宁市新民路34-18号中明大厦10楼D  
室, 530012  
Unit D, 10/F Zhongming Building, 34-18 Xinmin  
Road, Nanning, Guangxi, 530012, P.R. China  
电话(Tel): +86 771 282 7123  
传真(Fax): +86 771 282 7110

## 宁波 Ningbo

中国浙江省宁波市解放南路188号新园宾馆办公楼11  
楼D室, 315000  
Room D, 11/F, Xinyuan Hotel, 188 South Jiefang  
Road, Ningbo, Zhejiang, 315000, P.R. China  
电话(Tel): +86 574 8717 0322  
传真(Fax): +86 574 8731 8179

## 青岛 Qingdao

中国山东省青岛市香港中路12号丰合广场B区410室,  
266071  
Room 310, Area B of Fenghe Plaza, No. 12 Hong  
Kong Middle Road, Qingdao, Shandong, 266071,  
P.R. China  
电话(Tel): +86 532 8502 6396  
传真(Fax): +86 532 8502 6395

## 上海 Shanghai

中国上海市西藏中路268号来福士广场(办公楼)35楼,  
200001  
35th floor, Raffles City (Office 268 Xizang Zhong Lu,  
Shanghai, 200001, P.R. China  
电话(Tel): +86 21 6122 8888  
传真(Fax): +86 21 6122 8822

## 沈阳 Shenyang

中国辽宁省沈阳市和平区南京北街206号沈阳假日大厦城  
市广场二座3-166室, 110001  
Rm. 3-166, Tower II, City Plaza Shenyang No. 206,  
Nanjing North Street, Heping District, Shenyang, Liaoning,  
110001, P.R. China  
电话(Tel): +86 24 2334 1818  
传真(Fax): +86 24 2334 1306

## 深圳 Shenzhen

中国深圳市福田区福华三路与益田路交汇处  
168号深圳国际商会中心30楼3002-06, 518048  
Room 3002-06, 30/F, ShenZhen International Chamber  
of Commerce Tower, No. 168, Crossways of FuHua 3rd  
Road and YiTian Road, FuTian District, ShenZhen,  
518048, P.R. China  
电话(Tel): +86 755 8831 3088  
传真(Fax): +86 755 8831 3033

## 太原 Taiyuan

中国山西省太原市府西街69号山西国际贸易中心西塔  
楼10层1009A号, 030002  
Room 1009A, West Tower, International Trade Center,  
No. 69 Fuxi Street, Taiyuan, Shanxi, 030002,  
P.R. China  
电话(Tel): +86 351 868 9292  
传真(Fax): +86 351 868 9200

## 天津 Tianjin

中国天津市和平区南京路189号津汇广场写字楼3402室,  
300051  
Unit 3402, the Exchange North Tower, 189 Nanjing Road,  
Heping District, Tianjin, 300051, P.R. China  
电话(Tel): +86 22 8319 1801  
传真(Fax): +86 22 8319 1802/3

## 乌鲁木齐 Urumqi

中国新疆乌鲁木齐市中山路86号中泉广场9楼J座,  
830002  
9J Zhongquan Plaza, No. 86 Zhongshan Road, Urumqi,  
Sinkiang, 830002, P.R. China  
电话(Tel): +86 991 283 4455  
传真(Fax): +86 991 281 8240

## 武汉 Wuhan

中国湖北省武汉市武昌中南路七号中商广场写字楼34楼  
B3408, 430071  
B3408, 34/F, Zhongshang Plaza No.7, Zhongnan  
Road, Wuchang, Wuhan, Hubei, 430071, P.R. China  
电话(Tel): +86 27 8725 9222  
传真(Fax): +86 27 8725 9233

## 无锡 Wuxi

中国江苏省无锡市新生路107号新鼎球大厦10楼1012室,  
214001  
Room 1012, 10/F, Xin Ding Qiu Building, No. 107  
Xinsheng Road, Wuxi, Jiangsu, 214001, P.R. China  
电话(Tel): +86 510 279 1133  
传真(Fax): +86 510 275 1236

## 西安 Xi'an

中国陕西省西安市高新开发区高新路高新国际商务中心  
数码大厦16层, 710075  
16/F, Digital Building GaoXin Road, Hi-tech Zone, Xi'an,  
Shanxi, 710075, P.R. China  
电话(Tel): +86 29 8833 7288  
传真(Fax): +86 29 8575 8277/8575 8299

## 郑州 Zhengzhou

河南省郑州市中原西路220号裕达国际贸易中心A座  
2207室, 450007  
Room 2207, Tower A, Yuda International Trade Center  
220 Zhongyuan west Road, Zhengzhou, He'nan,  
450007, P.R. China  
电话(Tel): +86 371 6771 3588  
传真(Fax): +86 371 6771 3873



## ABB Shanghai Motors Co., LTD.

No.88 Tianning Road,  
Minhang(Economic & Technical Development  
Zone), Shanghai, 200245, P.R. China  
Tel: +86 21 5472 3133  
Fax: +86 21 5472 5025  
http: //www.abb.com.cn

## 上海ABB电机有限公司

中国上海闵行区经济技术开发区天宁路88号  
邮编: 200245  
电话: +86 21 5472 3133  
传真: +86 21 5472 5025  
网址: www.abb.com.cn